

Development Plan
 Seemore Outdoor Media Parcel
 Town of Aurora Eric County, New York
 C:\Tom\LOGD-2010\Final 2010 Logo no line.jpg

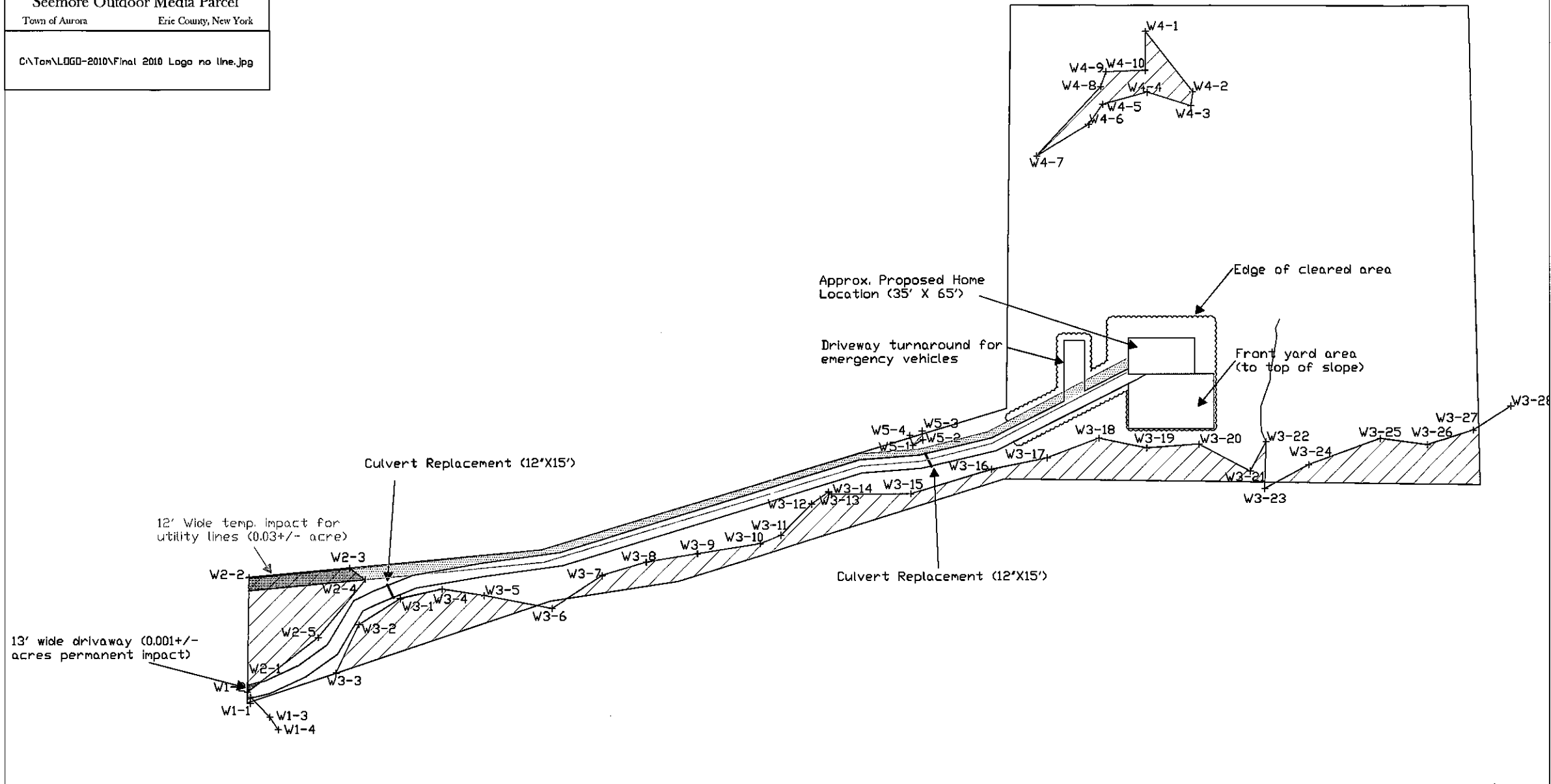

LEGEND	
	Limits of Investigation
	Drainages
	Wetland Area
	Wetland Boundary Flag
	Proposed 13' driveway
	12' Utility line impact
	Wetland Impacts

Wetland/Stream Identi#	Geographic Center (NAD83)		Boundary Flag	Total Area on Site, in square feet	Wetland/Stream Type	Jurisdictional Determination
	Latitude	Longitude				
Wetland 1	78.69677	42.76190	W1-1 through W1-	0.00a	Shallow Emergent Marsh (PEM)	Jurisdictional
Wetland 2	78.69661	42.76214	W2-1 through W2-5	0.18a	Shallow Emergent Marsh (PEM)	Jurisdictional
Wetland 3	78.69351	42.76245	W3-1 through W3-28	0.67a	Shallow Emergent Marsh / Hardwood Swamp (PEM/PEFS)	Jurisdictional
Wetland 4	78.69349	42.76548	W4-1 through W4-10	0.09a	Hardwood Swamp (PEFS)	Isolated
Wetland 5	78.69430	42.76249	W5-1 through W5-4	0.00a	Shallow Emergent Marsh (PEM)	Jurisdictional
Ditch 1	78.69306	42.76263		134.0 feet	Intermittent	Jurisdictional
Total Wetland Area:				0.94 ± acres		

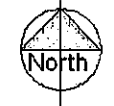

Scale:
 Map Date: June 27, 2011/ TJS for EDI
 Revised:
 Base Map Provided By: Garmin GPSmap 4-9 foot accuracy
 File Name: Wetland Delineation Map.dwg
 EDI Project Code: W13F11