



CASE NO. 1406

DATE OF HEARING 7/21/2022

Town of Aurora Zoning Board of Appeals  
300 Glead Avenue, East Aurora, New York 14052

### Zoning Board of Appeals Application Form

#### I. TYPE OF REQUEST

20

AREA VARIANCE     SPECIAL USE PERMIT     USE VARIANCE     INTERPRETATION

#### II. APPLICANT/PETITIONER

Applicant's Name WILLIAM T. VOEBL  
Address 270 BUFFALO RD UNIT 29  
City E. AURORA State NY ZIP 14052  
Phone 7 Fax — Email WTV@VOEBL.COM  
Interest owner/purchaser/developer OU

#### III. PROPERTY OWNER INFORMATION (If different from applicant information.)

Property Owner(s) Name(s) \_\_\_\_\_  
Address \_\_\_\_\_  
City \_\_\_\_\_ State \_\_\_\_\_ ZIP \_\_\_\_\_  
Phone \_\_\_\_\_ Fax \_\_\_\_\_ Email \_\_\_\_\_

#### III. PROPERTY INFORMATION

Property Address 1697 GROVER RD.  
SBL# 142489 199.00-2-8.21  
Property size in acres 4.38 Property Frontage in feet 112  
Zoning District RR/A Surrounding Zoning RR/A  
Current Use of Property BARN / GARDEN

#### IV. REQUEST DETAIL

(check all that apply)  
 Variance from Ordinance Section(s) # 99-31A(5)  
 Special Use Permit for: \_\_\_\_\_  
 Use Variance for: \_\_\_\_\_  
 Interpretation of \_\_\_\_\_

**V. SIGNATURES** (This application must be signed by the applicant/petitioner. If the applicant is not the owner of the property, a separate owner authorization form must be submitted – see pg. 5 )

William T Vogel  
Signature of Applicant/Petitioner

\_\_\_\_\_  
Print name of Applicant/Petitioner

State of New York; County of Erie

On the 26<sup>th</sup> day of May in the year 2022 before me, the above individual appeared, personally known to me on the basis of satisfactory evidence to be the individual whose name is subscribed to the within instrument and acknowledged to me that he/she/they executed the same for the purposes therein stated.

Brooke E Rule  
Notary Public

(Notary stamp)

BROOKE E RULE  
NOTARY PUBLIC STATE OF NEW YORK  
ERIE COUNTY  
LIC. #01RU6419099  
COMM. EXP. 06/28/2025

-----  
Office Use Only:      Date received: 5/31/22      Receipt #: 385784 CH3851

Application reviewed by: \_\_\_\_\_

ECDP ZR-1 form sent to EC: \_\_\_\_\_      Hearing publication date: \_\_\_\_\_

**PREVIOUS APPEAL(S):**

A previous appeal to the Zoning Board of Appeals ( ) has ( ) has not been made with respect to this property.

**Previous appeals:**

Date: \_\_\_\_\_ Type of Appeal: \_\_\_\_\_      Granted \_\_\_\_\_ Denied \_\_\_\_\_

Date: \_\_\_\_\_ Type of Appeal: \_\_\_\_\_      Granted \_\_\_\_\_ Denied \_\_\_\_\_

**PETITIONER'S LETTER OF INTENT**

Please describe in detail the proposed project, reason the variance and/or special use permit is being requested and any additional information that may be helpful to the Zoning Board of Appeals in deciding this appeal: (attach additional pages if needed)

BUILD A NEW HOME APPROX 2600 Sq FT -  
~~WAS~~ MY PERMIT SHOWS 40' FROM NORTH  
BORDER AND 314' FROM ROAD  
WANT TO GO BACK 354' OFF  
ROAD PLUS 90' OVER FROM NORTH  
BORDER  
REASON - BUFFER / PRIVACY FROM  
NEIGHBORS

**TO BE COMPLETED ONLY WHEN A USE VARIANCE IS BEING REQUESTED:**

A Use Variance is requested because the applicable regulations and restrictions in the Zoning Code of the Town of Aurora have caused unnecessary hardship as demonstrated by the following:

1) I cannot realize a reasonable return on my property for each and every permitted use allowed in the current zoning classification as demonstrated by the accompanying financial evidence (provide financial evidence to support your argument).

Financial Evidence Provided Yes  No  (financial evidence is required per NYS Town Law)

2) Describe why your alleged hardship relating to the subject property is unique and does not apply to other properties in the zoning district or neighborhood: \_\_\_\_\_  
\_\_\_\_\_  
\_\_\_\_\_

3) Describe why you believe that the essential character of the neighborhood/community will not change if the Zoning Board of Appeals grants you a use variance: \_\_\_\_\_  
\_\_\_\_\_  
\_\_\_\_\_

4) Is your need for a use variance a result of you own actions (is your difficulty self-created)? Please explain: \_\_\_\_\_  
\_\_\_\_\_

(Attach additional pages if needed)

SUPERVISOR  
James J. Bach  
(716) 652-7590  
[jbach@townofaurora.com](mailto:jbach@townofaurora.com)



TOWN CLERK  
Martha L. Librock  
(716) 652-3280  
[townclerk@townofaurora.com](mailto:townclerk@townofaurora.com)

**TOWN OF AURORA**  
**Aurora Municipal Center**  
575 Oakwood Avenue, East Aurora, NY 14052  
[www.townofaurora.com](http://www.townofaurora.com)

TOWN COUNCIL MEMBERS

Charles D. Snyder  
[csnyder@townofaurora.com](mailto:csnyder@townofaurora.com)

Luke Wochensky  
[lwochensky@townofaurora.com](mailto:lwochensky@townofaurora.com)

James F. Granville  
[jgranville@townofaurora.com](mailto:jgranville@townofaurora.com)

Joseph M. McCann  
[jmccann@townofaurora.com](mailto:jmccann@townofaurora.com)

SUPT. OF HIGHWAYS  
David M. Gunner  
(716) 652-4050  
[highway@townofaurora.com](mailto:highway@townofaurora.com)

CODE ENFORCEMENT  
OFFICER  
Elizabeth Cassidy  
(716) 652-7591  
[building@townofaurora.com](mailto:building@townofaurora.com)

ASSESSOR  
Roger P. Pigeon  
[assessor@townofaurora.com](mailto:assessor@townofaurora.com)  
(716) 652-0011

DIR. OF RECREATION  
Christopher Musshafen  
(716) 652-8866  
[chris@townofaurora.com](mailto:chris@townofaurora.com)

TOWN ATTORNEY  
Brigid M. Maloney

TOWN JUSTICE  
Jeffrey P. Markello  
Anthony DiFilippo IV

HISTORIAN  
Robert L. Goller  
(716) 652-7944  
[historian@townofaurora.com](mailto:historian@townofaurora.com)

FAX: (716) 652-3507

May 31, 2022

William Vogel  
270 Buffalo Rd, Unit 29  
East Aurora, NY 14052

Dear Bill:

The Building Department has denied your request to move the location of your proposed dwelling on your Open Development Area lot at 1697 Grover Rd because it fails to meet the current setback requirements for ODA lots.

Section 99-31A(5) Supplementary regulations/minimum standards  
Required: Front yard setback: 200 feet from the boundary line parallel to the street right-of-way  
Requested: Front yard setback of 60'  
Variance: 140'

This letter serves as notice that we have received the application and fee for the Zoning Board of Appeals. You will receive notification from the Town Clerk with the date and time of the hearing next month. If you have any questions, please contact our office at 652-7591.

Sincerely,

  
Elizabeth Cassidy  
Code Enforcement Officer

**SITE PLAN OR ZONING REFERRAL TO COUNTY OF ERIE, N.Y.  
AND REPLY TO MUNICIPALITY**

Submit this form with full statement of proposed action (as described in GML 239-m(c)) at www.Erie.gov/IRonline, OR mail a hard copy (retain a copy for your files) to: Erie County Division of Planning, 95 Franklin Street, Room 1053, Buffalo, N.Y., 14202

DO NOT WRITE IN THIS SPACE

Case No.: \_\_\_\_\_

Postmark/Delivery Date: \_\_\_\_\_

The proposed action described herein is referred in accordance with the provisions of NYS General Municipal Law §239 1 - nn  
A Municipal Referral Map is available to help determine whether an applicable action is subject to referral.

Description of Proposed Action

1. Name of Municipality: Town of Aurora

§239-m(4)(b) provides that the county shall have 30 days after receipt of a full statement of the proposed action to reply.

If the county fails to reply within such period, the referring body may take final action.

However, any county reply received after 30 days but 2 or more days prior to final action by the referring body shall be subject to §239-m(5)

The referring body shall file a report of its final action with the county within 30 days per §239-m(6).

2. Hearing Schedule:      Date 07/21/2022      Time 7:00pm      Location 575 Oakwood Ave, EA

3. Action is before:       Legislative Body       Board of Appeals       Planning Board

4. Action consists of:       New Ordinance       Rezone/Map Change       Ordinance Amendment

Site Plan       Variance       Special Use Permit       Other: \_\_\_\_\_

5. Location of Property:       Entire Municipality       Address: 1697 Grover Road

5a. S.B.L. of Property: 199.00-2-8.21

6. Referral required as site is within 500' of:       State or County Property/Institution       Municipal Boundary       Farm Operation located in an Agricultural District

Expressway       County Road       State Highway       Proposed State or County Road, Property, Building/Institution, Drainageway

7. Proposed change or use: requesting 60' front yard setback for new house - 200' required by code  
(specify the action, such as the scope of variances or site plans)

8. Other remarks: this is an open devepment area lot (flag lot)

9. Submitted by: Martha Librock      Email: townclerk@townofaurora.com

10. Return Address: 575 Oakwood Avenue, East Aurora, NY 14052

Reply to Municipality by Erie County Division of Planning

Receipt of the above-described proposed action is acknowledged on \_\_\_\_\_. The Division herewith submits its review and reply under the provisions of applicable state and local law, based on the information submitted with this referral.

1.  The proposed action is not subject to review under the law.
2.  Comment on proposed action is attached hereto.
3.  The proposed action is subject to review; Recommendation on Proposed Action is attached hereto.
4.  No Recommendation; proposed action has been reviewed and determined to be of local concern.

By the Division of Planning: \_\_\_\_\_ Date: \_\_\_\_\_

## Short Environmental Assessment Form

### Part 1 - Project Information

#### Instructions for Completing

**Part 1 - Project Information.** The applicant or project sponsor is responsible for the completion of Part 1. Responses become part of the application for approval or funding, are subject to public review, and may be subject to further verification. Complete Part 1 based on information currently available. If additional research or investigation would be needed to fully respond to any item, please answer as thoroughly as possible based on current information.

Complete all items in Part 1. You may also provide any additional information which you believe will be needed by or useful to the lead agency; attach additional pages as necessary to supplement any item.

<b>Part 1 - Project and Sponsor Information</b>							
Name of Action or Project: <i>NEW HOUSE - WILLIAM T. VOGEL</i>							
Project Location (describe, and attach a location map): <i>NEW BUILD</i>							
Project Location (describe, and attach a location map): <i>1697 GROVER RD AURORA NY 14052</i>							
Brief Description of Proposed Action: <i>BUILD A NEW HOME APPROX 2600 SQ FT 334' BACK OF ROAD - 90' SOUTH OF NORTH BORDER</i>							
Name of Applicant or Sponsor: <i>WILLIAM T. VOGEL</i>		Telephone: <i>716</i>	<i>3</i>				
E-Mail:							
Address: <i>270 BUFFALO RD UNIT 29 E. AURORA NY 14052</i>							
City/PO: <i>E. AURORA</i>		State: <i>NY</i>	Zip Code: <i>14052</i>				
1. Does the proposed action only involve the legislative adoption of a plan, local law, ordinance, administrative rule, or regulation? If Yes, attach a narrative description of the intent of the proposed action and the environmental resources that may be affected in the municipality and proceed to Part 2. If no, continue to question 2.			<table border="1" style="width: 100%; border-collapse: collapse;"> <tr> <td style="width: 50%; text-align: center;">NO</td> <td style="width: 50%; text-align: center;">YES</td> </tr> <tr> <td style="text-align: center;"><input checked="" type="checkbox"/></td> <td style="text-align: center;"><input type="checkbox"/></td> </tr> </table>	NO	YES	<input checked="" type="checkbox"/>	<input type="checkbox"/>
NO	YES						
<input checked="" type="checkbox"/>	<input type="checkbox"/>						
2. Does the proposed action require a permit, approval or funding from any other governmental Agency? If Yes, list agency(s) name and permit or approval:			<table border="1" style="width: 100%; border-collapse: collapse;"> <tr> <td style="width: 50%; text-align: center;">NO</td> <td style="width: 50%; text-align: center;">YES</td> </tr> <tr> <td style="text-align: center;"><input checked="" type="checkbox"/></td> <td style="text-align: center;"><input type="checkbox"/></td> </tr> </table>	NO	YES	<input checked="" type="checkbox"/>	<input type="checkbox"/>
NO	YES						
<input checked="" type="checkbox"/>	<input type="checkbox"/>						
3.a. Total acreage of the site of the proposed action?		<i>4.38</i> acres					
b. Total acreage to be physically disturbed?		<i>2600 SQ FT PLUS GARAGE</i>					
c. Total acreage (project site and any contiguous properties) owned or controlled by the applicant or project sponsor?		<i>4.38</i> acres					
4. Check all land uses that occur on, adjoining and near the proposed action.							
<input type="checkbox"/> Urban <input checked="" type="checkbox"/> Rural (non-agriculture) <input type="checkbox"/> Industrial <input type="checkbox"/> Commercial <input type="checkbox"/> Residential (suburban) <input type="checkbox"/> Forest <input checked="" type="checkbox"/> Agriculture <input type="checkbox"/> Aquatic <input type="checkbox"/> Other (specify): _____ <input type="checkbox"/> Parkland							

5. Is the proposed action, a. A permitted use under the zoning regulations?	<input type="checkbox"/>	<input checked="" type="checkbox"/>	<input type="checkbox"/>
b. Consistent with the adopted comprehensive plan?	<input type="checkbox"/>	<input checked="" type="checkbox"/>	<input type="checkbox"/>
6. Is the proposed action consistent with the predominant character of the existing built or natural landscape?	<input type="checkbox"/>	<input checked="" type="checkbox"/>	<input type="checkbox"/>
7. Is the site of the proposed action located in, or does it adjoin, a state listed Critical Environmental Area? If Yes, identify: _____	<input checked="" type="checkbox"/>	<input type="checkbox"/>	<input type="checkbox"/>
8. a. Will the proposed action result in a substantial increase in traffic above present levels?	<input checked="" type="checkbox"/>	<input type="checkbox"/>	<input type="checkbox"/>
b. Are public transportation service(s) available at or near the site of the proposed action?	<input checked="" type="checkbox"/>	<input type="checkbox"/>	<input type="checkbox"/>
c. Are any pedestrian accommodations or bicycle routes available on or near site of the proposed action?	<input checked="" type="checkbox"/>	<input type="checkbox"/>	<input type="checkbox"/>
9. Does the proposed action meet or exceed the state energy code requirements? If the proposed action will exceed requirements, describe design features and technologies: <u>RADIATE HEAT</u>	<input type="checkbox"/>	<input checked="" type="checkbox"/>	<input type="checkbox"/>
10. Will the proposed action connect to an existing public/private water supply? If No, describe method for providing potable water: <u>PUBLIC WATER</u>	<input type="checkbox"/>	<input checked="" type="checkbox"/>	<input type="checkbox"/>
11. Will the proposed action connect to existing wastewater utilities? If No, describe method for providing wastewater treatment: <u>SEPTIC</u>	<input checked="" type="checkbox"/>	<input type="checkbox"/>	<input type="checkbox"/>
12. a. Does the site contain a structure that is listed on either the State or National Register of Historic Places?	<input checked="" type="checkbox"/>	<input type="checkbox"/>	<input type="checkbox"/>
b. Is the proposed action located in an archeological sensitive area?	<input checked="" type="checkbox"/>	<input type="checkbox"/>	<input type="checkbox"/>
13. a. Does any portion of the site of the proposed action, or lands adjoining the proposed action, contain wetlands or other waterbodies regulated by a federal, state or local agency?	<input checked="" type="checkbox"/>	<input type="checkbox"/>	<input type="checkbox"/>
b. Would the proposed action physically alter, or encroach into, any existing wetland or waterbody? If Yes, identify the wetland or waterbody and extent of alterations in square feet or acres: _____	<input checked="" type="checkbox"/>	<input type="checkbox"/>	<input type="checkbox"/>
14. Identify the typical habitat types that occur on, or are likely to be found on the project site. Check all that apply: <input type="checkbox"/> Shoreline <input type="checkbox"/> Forest <input checked="" type="checkbox"/> Agricultural/grasslands <input type="checkbox"/> Early mid-successional <input type="checkbox"/> Wetland <input type="checkbox"/> Urban <input type="checkbox"/> Suburban			
15. Does the site of the proposed action contain any species of animal, or associated habitats, listed by the State or Federal government as threatened or endangered?	<input checked="" type="checkbox"/>	<input type="checkbox"/>	<input type="checkbox"/>
16. Is the project site located in the 100 year flood plain?	<input checked="" type="checkbox"/>	<input type="checkbox"/>	<input type="checkbox"/>
17. Will the proposed action create storm water discharge, either from point or non-point sources? If Yes, a. Will storm water discharges flow to adjacent properties? <input checked="" type="checkbox"/> NO <input type="checkbox"/> YES b. Will storm water discharges be directed to established conveyance systems (runoff and storm drains)? If Yes, briefly describe: _____ <input checked="" type="checkbox"/> NO <input type="checkbox"/> YES	<input checked="" type="checkbox"/>	<input type="checkbox"/>	<input type="checkbox"/>

18. Does the proposed action include construction or other activities that result in the impoundment of water or other liquids (e.g. retention pond, waste lagoon, dam)? If Yes, explain purpose and size: _____ _____ _____	NO <input checked="" type="checkbox"/>	YES <input type="checkbox"/>
19. Has the site of the proposed action or an adjoining property been the location of an active or closed solid waste management facility? If Yes, describe: _____ _____ _____	NO <input checked="" type="checkbox"/>	YES <input type="checkbox"/>
20. Has the site of the proposed action or an adjoining property been the subject of remediation (ongoing or completed) for hazardous waste? If Yes, describe: _____ _____ _____	NO <input checked="" type="checkbox"/>	YES <input type="checkbox"/>
<b>I AFFIRM THAT THE INFORMATION PROVIDED ABOVE IS TRUE AND ACCURATE TO THE BEST OF MY KNOWLEDGE</b>		
Applicant/sponsor name: <u>WILLIAM T. VOCEL</u> Date: <u>5/17/22</u> Signature: <u>William T. Vogel</u>		





#1406

# Erie County On-Line Mapping Application

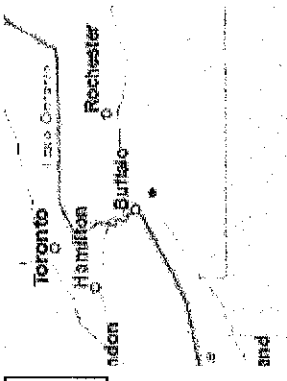

### Legend

□ Parcels

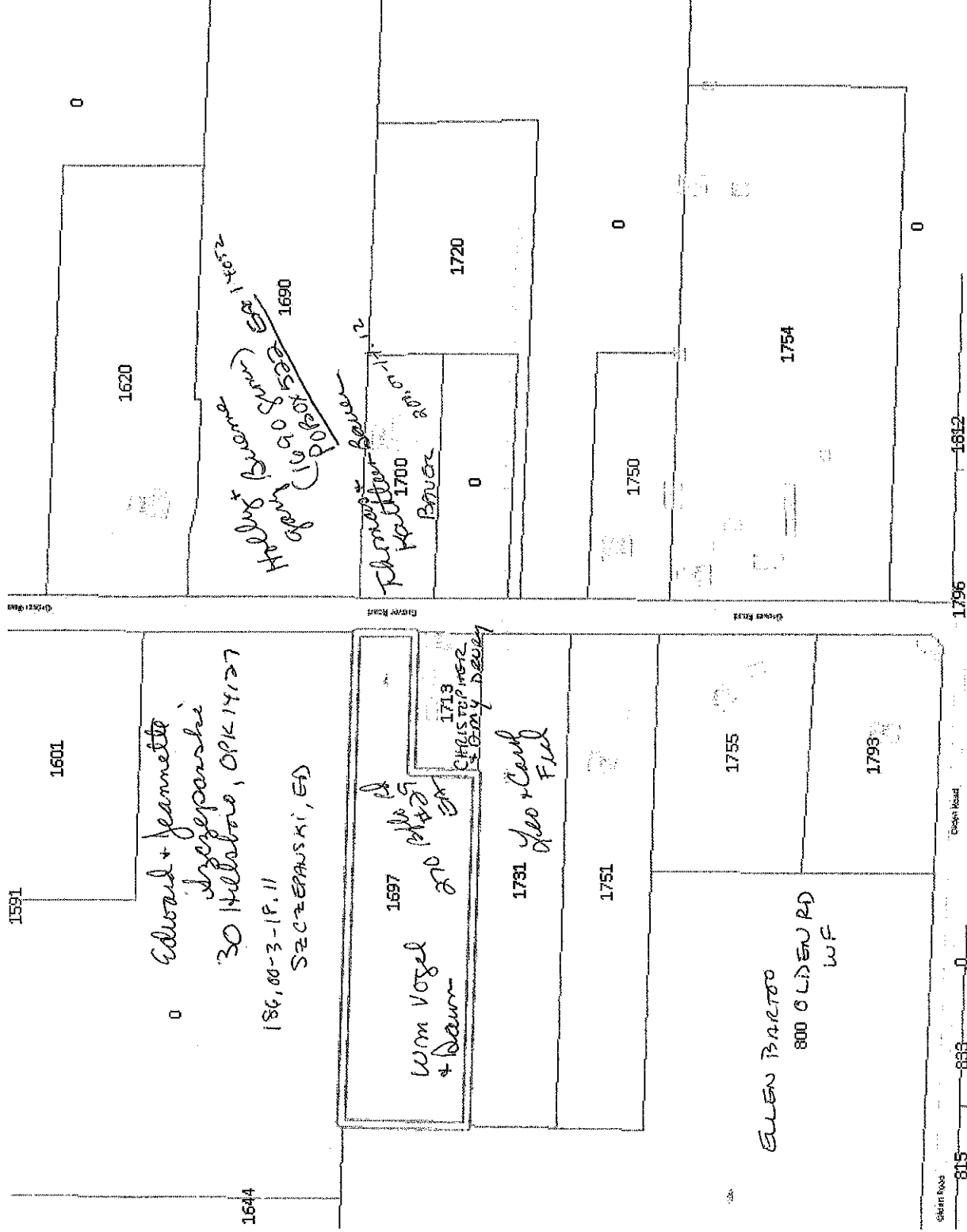

This map is a user generated static output from an Internet mapping site and is for reference only. Data layers that appear on this map may or may not be accurate, current, or otherwise reliable.

**ERIE COUNTY**  
**DEPARTMENT OF ENVIRONMENT & PLANNING**  
**OFFICE OF GIS**

0 0.07 0.1 Miles  
WGS\_1984\_Web\_Mercator\_Auxiliary\_Sphere  
THIS MAP IS NOT TO BE USED FOR NAVIGATION

1: 4,514