

ORIGINAL



CASE NO. 1478

DATE OF HEARING 7/18/24

Town of Aurora Zoning Board of Appeals
575 Oakwood Avenue, East Aurora, New York 14052

Zoning Board of Appeals Application Form

I. TYPE OF REQUEST

AREA VARIANCE SPECIAL USE PERMIT USE VARIANCE INTERPRETATION

II. APPLICANT/PETITIONER

Applicant's Name Alex Handley
Address 12744 Bull's Rd.
City East Aurora State NY ZIP 14052
Phone _____ Fax _____ Email alex
Interest _____ ner/purchaser/developer) OWNER om

III. PROPERTY INFORMATION (If different from applicant)

Property Owner(s) Name(s) _____
Address _____
City _____ State _____ ZIP _____
Phone _____ Fax _____ Email _____

III. PROPERTY INFORMATION

Property Address 2271 Lapham Rd., East Aurora, NY, 14052
SBL# 176.04-3-20
Property size in acres 42.39 Property Frontage in feet 68.70 LF
Zoning District RR1A Surrounding Zoning RR1A
Current Use of Property Recreational / U/L

IV. REQUEST DETAIL

(check all that apply)
 Variance from Ordinance Section(s) # 99-31A(2); 99-31A(3); 99-31A(9)
 Special Use Permit for: _____
 Use Variance for: _____
 Interpretation of _____

V. SIGNATURES (This application must be signed by the applicant/petitioner. If the applicant is not the owner of the property, a separate owner authorization form must be submitted – see pg. 5)

Alex Handley

Signature of Applicant/Petitioner

Alex Handley

Print name of Applicant/Petitioner

State of New York; County of Erie

On the 11th day of June in the year 2024 before me, the above individual appeared, personally known to me on the basis of satisfactory evidence to be the individual whose name is subscribed to the within instrument and acknowledged to me that he/she/they executed the same for the purposes therein stated.

Megan Wasileff

Notary Public

(Notary stamp)

Megan Wasileff
NOTARY PUBLIC, STATE OF NEW YORK
Registration No. 01WA6289790
Qualified in Erie County
Commission Expires September 30, 2025

Office Use Only: Date received: _____ Receipt #: _____

Application reviewed by: _____

ECDP ZR-1 form sent to EC: _____ Hearing publication date: _____

PREVIOUS APPEAL(S):

A previous appeal to the Zoning Board of Appeals () has () has not been made with respect to this property.

Previous appeals:

Date: _____ Type of Appeal: _____ Granted _____ Denied _____

Date: _____ Type of Appeal: _____ Granted _____ Denied _____

PETITIONER'S LETTER OF INTENT

Please describe in detail the proposed project, reason the variance and/or special use permit is being requested and any additional information that may be helpful to the Zoning Board of Appeals in deciding this appeal: (attach additional pages if needed)

My interest in this variance is to obtain permission from the town to be able to build a permanent residence not currently permitted by flag lot frontage requirements. It is my understanding the current maximum is 75 linear feet. My lot provides 68.70 linear feet. I'm hoping the town will agree that the property layout is somewhat different from typical flag lots the town is trying to monitor, due to the fact that where I would like to build, it would be very hard to see from the road or any neighbors even.

TO BE COMPLETED ONLY WHEN A USE VARIANCE IS BEING REQUESTED:

A Use Variance is requested because the applicable regulations and restrictions in the Zoning Code of the Town of Aurora have caused unnecessary hardship as demonstrated by the following:

- 1) I cannot realize a reasonable return on my property for each and every permitted use allowed in the current zoning classification as demonstrated by the accompanying financial evidence (provide financial evidence to support your argument).

Financial Evidence Provided Yes No (financial evidence is required per NYS Town Law)

- 2) Describe why your alleged hardship relating to the subject property is unique and does not apply to other properties in the zoning district or neighborhood: _____

- 3) Describe why you believe that the essential character of the neighborhood/community will not change if the Zoning Board of Appeals grants you a use variance: _____

- 4) Is your need for a use variance a result of you own actions (is your difficulty self-created)? Please explain: _____

(Attach additional pages if needed)

Town of Aurora
575 Oakwood Avenue
East Aurora, NY 14052
www.townofaurora.com

**Zoning Board of Appeals
Application
Owner Authorization**

The undersigned, who is the owner of the premises know as:

2271 Lapham Rd., East Aurora, NY 14052, identified as Tax Map (SBL)#.....
(address)

hereby authorizes Alex Handley to bring an application for area variance
 special use permit use variance interpretation before the Town of Aurora Zoning Board of
Appeals for review and potential approval. The undersigned further permits the Town or its authorized
representative(s) access to the property to review existing site conditions during the review process.

Alex Handley
Owner (print)

06/11/24
Date

Alex Handley
Owner (signature)

STATE OF NEW YORK)
) SS
COUNTY OF ERIE)

On this 11th day of June, 2024, before me, the undersigned, a notary public in and for said state,
personally appeared Alex Handley, personally known to me on the basis of
satisfactory evidence to be the individual(s) whose name(s) is (are) subscribed to the within instrument and
acknowledged to me that he/she/they executed the same in his/her/their capacity(ies), and that by his/her/their
signature(s) on the instrument, the individual(s), or the person upon behalf of which the individual(s) acted,
executed the instrument.

Megan Wasileff
Notary Public

Megan Wasileff
NOTARY PUBLIC, STATE OF NEW YORK
Registration No. 01WA6299790
Qualified in Erie County
Commission Expires September 30, 2025

SUPERVISOR
Charles D. Snyder
(716) 652-7590
csnyder@townofaurora.com



TOWN CLERK
Martha L. Libroch
(716) 652-3280
townclerk@townofaurora.com

TOWN OF AURORA

Aurora Municipal Center
575 Oakwood Avenue, East Aurora, NY 14052
www.townofaurora.com

TOWN COUNCIL MEMBERS

Luke Wochensky
lwochensky@townofaurora.com

James F. Granville
jgranville@townofaurora.com

Joseph M. McCann
jmccann@townofaurora.com

Raymond M. Wrazen
rwrazen@townofaurora.com

SUPT. OF HIGHWAYS
David M. Gunner
(716) 652-4050
highway@townofaurora.com

CODE ENFORCEMENT
OFFICER
Elizabeth Cassidy
(716) 652-7591
building@townofaurora.com

ASSESSOR
Stephen R. Pigeon
assessor@townofaurora.com
(716) 652-0011

DIR. OF RECREATION
Christopher Musshafen
(716) 652-8866
chris@townofaurora.com

TOWN ATTORNEY
Brigid M. Maloney

TOWN JUSTICE
Jeffrey P. Markello
Anthony DiFilippo IV

HISTORIAN
Robert L. Goller
(716) 652-7944
historian@townofaurora.com

FAX: (716) 652-3507

Alex Handley
12744 Bullis Rd
East Aurora, NY 14052

June 12, 2024

Alex:

The Building Department has reviewed your request to construct a residence at your property at 2271 Lapham Rd. The request has been denied because it fails to meet the code requirements for development on an ODA lot in the Town. Please note that the property was previously granted a zoning variance on 10/20/22 in case 1421 but that variance expired as per Town Code 116-91H.

Section 99-31A(2)

Required: The flagpole portion of the lot must have a minimum of 75' of frontage on an existing ROW

Requested: Existing ODA lot with 68.7' at ROW

Variance: 6.3'

Section 99-31A(3)

Required: All access roadways will be located on a private ROW at least 75' wide.

Requested: Existing ROW with the narrowest dimension of 66'

Variance: 9'

This letter serves as notice that we have received the application and fee for the Zoning Board of Appeals. You will receive notification from the Town Clerk with the date and time of the next available hearing. If you have any questions, please contact our office at 652-7591.

Sincerely,

Elizabeth Cassidy
Code Enforcement Officer

**SITE PLAN OR ZONING REFERRAL TO COUNTY OF ERIE, N.Y.
AND REPLY TO MUNICIPALITY**

Submit this form with full statement of proposed action (as described in GML 239-m(c)) at www.Erie.gov/IRonline, OR mail a hard copy (retain a copy for your files) to: Erie County Division of Planning, 95 Franklin Street, Room 1053, Buffalo, N.Y., 14202

DO NOT WRITE IN THIS SPACE

Case No.: _____

Postmark/Delivery Date: _____

The proposed action described herein is referred in accordance with the provisions of NYS General Municipal Law §239 1 - nn.
A Municipal Referral Map is available to help determine whether an applicable action is subject to referral.

Description of Proposed Action

1. Name of Municipality: Town of Aurora

§239-m(4)(b) provides that the county shall have 30 days after receipt of a full statement of the proposed action to reply.

If the county fails to reply within such period, the referring body may take final action.

However, any county reply received after 30 days but 2 or more days prior to final action by the referring body shall be subject to §239-m(5)

The referring body shall file a report of its final action with the county within 30 days per §239-m(6).

2. Hearing Schedule: **Date** 7/18/2024 **Time** 7:00pm **Location** 575 Oakwood Ave, E Aurora

3. Action is before: Legislative Body Board of Appeals Planning Board

4. Action consists of: New Ordinance Rezone/Map Change Ordinance Amendment

Site Plan Variance Special Use Permit Other: _____

5. Location of Property: Entire Municipality Address: 2271 Lapham Rd

5a. S.B.L. of Property: 176.00-3-20

6. Referral required as site is within 500' of: State or County Property/Institution Municipal Boundary Farm Operation located in an Agricultural District

Expressway County Road State Highway Proposed State or County Road, Property, Building/Institution, Drainageway

7. Proposed change or use: Development (proposed residence) on an Open Development Area (flag) lot requires frontage and ingress/egress width variances.
(specify the action, such as the scope of variances or site plans)

8. Other remarks: _____

9. Submitted by: Martha Librock, Town Clerk Email: townclerk@townofaurora.com

10. Return Address: 575 Oakwood Ave., E. Aurora, NY 14052

Reply to Municipality by Erie County Division of Planning

Receipt of the above-described proposed action is acknowledged on _____. The Division herewith submits its review and reply under the provisions of applicable state and local law, based on the information submitted with this referral.

1. The proposed action is not subject to review under the law.
2. Comment on proposed action is attached hereto.
3. The proposed action is subject to review; Recommendation on Proposed Action is attached hereto.
4. No Recommendation; proposed action has been reviewed and determined to be of local concern.

By the Division of Planning: _____ Date: _____

Short Environmental Assessment Form

Part 1 - Project Information

Instructions for Completing

Part 1 – Project Information. The applicant or project sponsor is responsible for the completion of Part 1. Responses become part of the application for approval or funding, are subject to public review, and may be subject to further verification. Complete Part 1 based on information currently available. If additional research or investigation would be needed to fully respond to any item, please answer as thoroughly as possible based on current information.

Complete all items in Part 1. You may also provide any additional information which you believe will be needed by or useful to the lead agency; attach additional pages as necessary to supplement any item.

Part 1 – Project and Sponsor Information			
Name of Action or Project: Alex Handley: Building a Permanent Residence			
Project Location (describe, and attach a location map): 2271 Lapham Rd., East Aurora, NY, 14052			
Brief Description of Proposed Action: The plan would be to build my permanent on the property. A 2,100 sq. Ft house is what is currently have stamped plans for.			
Name of Applicant or Sponsor: Alex Handley	Teleph 3	E-Mail @yahoo.com	
Address: 12744 Bullis Rd.			
City/PO: East Aurora	State: Ny	Zip Code: 14052	
1. Does the proposed action only involve the legislative adoption of a plan, local law, ordinance, administrative rule, or regulation? If Yes, attach a narrative description of the intent of the proposed action and the environmental resources that may be affected in the municipality and proceed to Part 2. If no, continue to question 2.		NO <input checked="" type="checkbox"/>	YES <input type="checkbox"/>
2. Does the proposed action require a permit, approval or funding from any other government Agency? If Yes, list agency(s) name and permit or approval: Town of East Aurora Building Department		NO <input type="checkbox"/>	YES <input checked="" type="checkbox"/>
3. a. Total acreage of the site of the proposed action? b. Total acreage to be physically disturbed? c. Total acreage (project site and any contiguous properties) owned or controlled by the applicant or project sponsor?		3.6 acres	4 acres
4. Check all land uses that occur on, are adjoining or near the proposed action:		42.5 acres	
<input type="checkbox"/> Urban <input checked="" type="checkbox"/> Rural (non-agriculture) <input type="checkbox"/> Industrial <input type="checkbox"/> Commercial <input type="checkbox"/> Residential (suburban) <input checked="" type="checkbox"/> Forest <input checked="" type="checkbox"/> Agriculture <input type="checkbox"/> Aquatic <input type="checkbox"/> Other(Specify): <input type="checkbox"/> Parkland			

5. Is the proposed action,	NO	YES	N/A
a. A permitted use under the zoning regulations?	<input checked="" type="checkbox"/>	<input type="checkbox"/>	<input type="checkbox"/>
b. Consistent with the adopted comprehensive plan?	<input type="checkbox"/>	<input checked="" type="checkbox"/>	<input type="checkbox"/>
6. Is the proposed action consistent with the predominant character of the existing built or natural landscape?	NO	YES	
	<input type="checkbox"/>	<input checked="" type="checkbox"/>	
7. Is the site of the proposed action located in, or does it adjoin, a state listed Critical Environmental Area?	NO	YES	
If Yes, identify: _____	<input checked="" type="checkbox"/>	<input type="checkbox"/>	
8. a. Will the proposed action result in a substantial increase in traffic above present levels?	NO	YES	
b. Are public transportation services available at or near the site of the proposed action?	<input checked="" type="checkbox"/>	<input type="checkbox"/>	
c. Are any pedestrian accommodations or bicycle routes available on or near the site of the proposed action?	<input checked="" type="checkbox"/>	<input type="checkbox"/>	
9. Does the proposed action meet or exceed the state energy code requirements?	NO	YES	
If the proposed action will exceed requirements, describe design features and technologies: <u>House Plans to be compliant with state energy code.</u>	<input type="checkbox"/>	<input checked="" type="checkbox"/>	
10. Will the proposed action connect to an existing public/private water supply?	NO	YES	
If No, describe method for providing potable water: _____	<input type="checkbox"/>	<input checked="" type="checkbox"/>	
11. Will the proposed action connect to existing wastewater utilities?	NO	YES	
If No, describe method for providing wastewater treatment: <u>No, I have own plans written by an engineer for a sand filter septic system.</u>	<input checked="" type="checkbox"/>	<input type="checkbox"/>	
12. a. Does the project site contain, or is it substantially contiguous to, a building, archaeological site, or district which is listed on the National or State Register of Historic Places, or that has been determined by the Commissioner of the NYS Office of Parks, Recreation and Historic Preservation to be eligible for listing on the State Register of Historic Places?	NO	YES	
	<input checked="" type="checkbox"/>	<input type="checkbox"/>	
b. Is the project site, or any portion of it, located in or adjacent to an area designated as sensitive for archaeological sites on the NY State Historic Preservation Office (SHPO) archaeological site inventory?	<input checked="" type="checkbox"/>	<input type="checkbox"/>	
13. a. Does any portion of the site of the proposed action, or lands adjoining the proposed action, contain wetlands or other waterbodies regulated by a federal, state or local agency?	NO	YES	
	<input checked="" type="checkbox"/>	<input type="checkbox"/>	
b. Would the proposed action physically alter, or encroach into, any existing wetland or waterbody?	<input checked="" type="checkbox"/>	<input type="checkbox"/>	
If Yes, identify the wetland or waterbody and extent of alterations in square feet or acres: _____			

14. Identify the typical habitat types that occur on, or are likely to be found on the project site. Check all that apply:

Shoreline Forest Agricultural/grasslands Early mid-successional

Wetland Urban Suburban

15. Does the site of the proposed action contain any species of animal, or associated habitats, listed by the State or Federal government as threatened or endangered?	NO	YES
	<input checked="" type="checkbox"/>	<input type="checkbox"/>
16. Is the project site located in the 100-year flood plan?	NO	YES
	<input checked="" type="checkbox"/>	<input type="checkbox"/>
17. Will the proposed action create storm water discharge, either from point or non-point sources? If Yes,	NO	YES
a. Will storm water discharges flow to adjacent properties?	<input checked="" type="checkbox"/>	<input type="checkbox"/>
b. Will storm water discharges be directed to established conveyance systems (runoff and storm drains)?	<input checked="" type="checkbox"/>	<input type="checkbox"/>
If Yes, briefly describe: _____ _____		
18. Does the proposed action include construction or other activities that would result in the impoundment of water or other liquids (e.g., retention pond, waste lagoon, dam)? If Yes, explain the purpose and size of the impoundment: _____	NO	YES
	<input checked="" type="checkbox"/>	<input type="checkbox"/>
19. Has the site of the proposed action or an adjoining property been the location of an active or closed solid waste management facility? If Yes, describe: _____	NO	YES
	<input checked="" type="checkbox"/>	<input type="checkbox"/>
20. Has the site of the proposed action or an adjoining property been the subject of remediation (ongoing or completed) for hazardous waste? If Yes, describe: _____	NO	YES
	<input checked="" type="checkbox"/>	<input type="checkbox"/>

I CERTIFY THAT THE INFORMATION PROVIDED ABOVE IS TRUE AND ACCURATE TO THE BEST OF MY KNOWLEDGE

Applicant/sponsor/name: Alex Handley Date: 06/11/24

Signature: *Alex Handley* Title: _____

Erie County On-Line Mapping Application

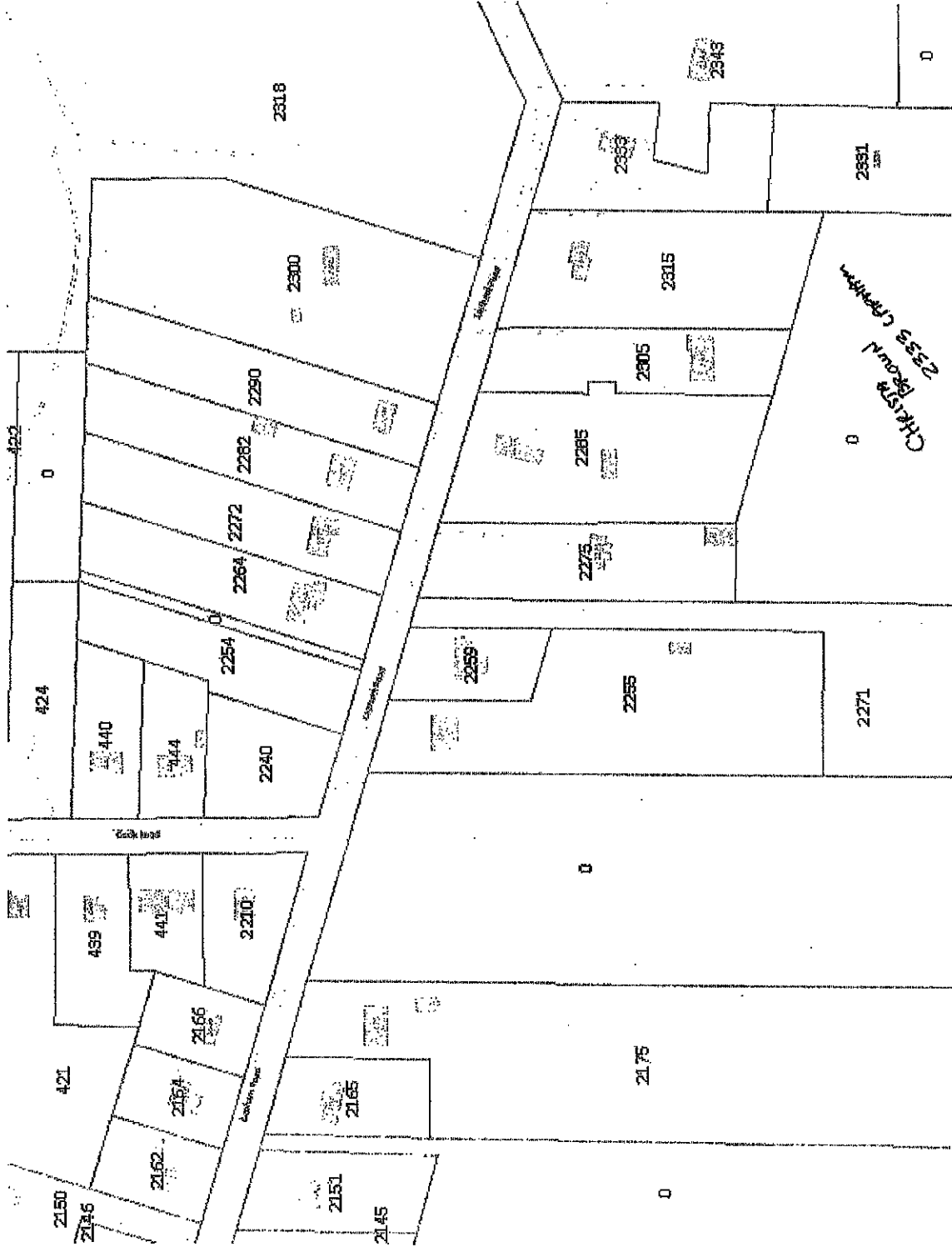

Legend

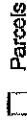

Parcels

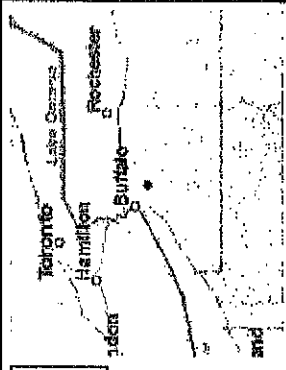

0 0.07 0.1 Miles

WGS 1984 Web Mercator Auxiliary Sphere
THIS MAP IS NOT TO BE USED FOR NAVIGATION

**ERIE COUNTY
DEPARTMENT OF ENVIRONMENT & PLANNING
OFFICE OF GIS**

This map is a user generated static output from an internet mapping site and is for reference only. Data layers that appear on this map may or may not be accurate, current, or otherwise reliable.

1: 4,514

10/2

