



CASE NO. 1476
DATE OF HEARING 7/18/2021

Town of Aurora Zoning Board of Appeals
575 Oakwood Avenue, East Aurora, New York 14052

Zoning Board of Appeals Application Form

I. TYPE OF REQUEST

AREA VARIANCE SPECIAL USE PERMIT USE VARIANCE INTERPRETATION

II. APPLICANT/PETITIONER

Applicant's Name Donald Sendor Eileen Crotty Sendor
Address 135 Cook Rd
City East Aurora State N.Y. ZIP 14052
Phone 716 661-1111 il dot com
Interest in the pr av

III. PROPERTY OWNER INFORMATION (If different from applicant information.)

Property Owner(s) Name(s) _____
Address _____
City _____ State _____ ZIP _____
Phone _____ Fax _____ Email _____

III. PROPERTY INFORMATION

Property Address 135 Cook Road
SBL# 176.00-1-33.1
Property size in acres 7.8 Property Frontage in feet 266.50
Zoning District RR/A Surrounding Zoning RR/A & R
Current Use of Property Residential

IV. REQUEST DETAIL

(check all that apply)

Variance from Ordinance Section(s) # 116-B.4F(4)
 Special Use Permit for: _____
 Use Variance for: _____
 Interpretation of _____

V. SIGNATURES (This application must be signed by the applicant/petitioner. If the applicant is not the owner of the property, a separate owner authorization form must be submitted – see pg. 5)

Eileen Crotty Donald R Sendor
Signature of Applicant/Petitioner

Eileen Crotty Donald R Sendor
Print name of Applicant/Petitioner

State of New York; County of Erie

On the 6th day of June in the year 2024 before me, the above individual appeared, personally known to me on the basis of satisfactory evidence to be the individual whose name is subscribed to the within instrument and acknowledged to me that he/she/they executed the same for the purposes therein stated.

Sheryla A. Miller
Notary Public
(Notary stamp) **SHERYLA. MILLER**
Reg. #01MI6128663
Notary Public, State of New York
Qualified In Erie County
Commission Expires June 13, 2025

Office Use Only: Date received: 6/10/2024 Receipt #: 114523

Application reviewed by: _____

ECDP ZR-1 form sent to EC: _____ Hearing publication date: _____

PREVIOUS APPEAL(S):

A previous appeal to the Zoning Board of Appeals () has () has not been made with respect to this property.

Previous appeals:

Date: _____ Type of Appeal: _____ Granted _____ Denied _____

Date: _____ Type of Appeal: _____ Granted _____ Denied _____

PETITIONER'S LETTER OF INTENT

Please describe in detail the proposed project, reason the variance and/or special use permit is being requested and any additional information that may be helpful to the Zoning Board of Appeals in deciding this appeal: (attach additional pages if needed)

Put a Shed - Garage on 20A / Cook Road parcel. The shed-garage to be in front of house in the Cook Road parcel. Access for tractor - 4' snow blower - attachments 3pt - plow - implements can only be achieved in this location. Rear area is septic tank - leach field - valley level - recreation area.

TO BE COMPLETED ONLY WHEN A USE VARIANCE IS BEING REQUESTED:

A Use Variance is requested because the applicable regulations and restrictions in the Zoning Code of the Town of Aurora have caused unnecessary hardship as demonstrated by the following:

1) I cannot realize a reasonable return on my property for each and every permitted use allowed in the current zoning classification as demonstrated by the accompanying financial evidence (provide financial evidence to support your argument).
 Financial Evidence Provided Yes ___ No ___ (financial evidence is required per NYS Town Law)

2) Describe why your alleged hardship relating to the subject property is unique and does not apply to other properties in the zoning district or neighborhood: _____

3) Describe why you believe that the essential character of the neighborhood/community will not change if the Zoning Board of Appeals grants you a use variance: _____

4) Is your need for a use variance a result of you own actions (is your difficulty self-created)? Please explain: _____

(Attach additional pages if needed)

Town of Aurora
Building-Zoning Department

From Eileen Crotty--Sendor
Don Sendor
135 Cook Road
East Aurora NY 14052

d
7

Subject-Shed-Garage—24 feet—x—24 feet-placed on 26x26 #2 gravel pad

Hello,

We would like to place the structure to our upper left corner lot about 70 feet (back right corner of structure) and about 90 feet from Cook Road (right of way). We have septic -leach-drain field- volley ball-play area in back left-hand side of property-(toward 20A) not accessible in winter for tractor-implements. The current house right side (Lapham Road) has water-gas electric utilities.

Several neighbors on our street have sheds-structures in front of house. The proposed structure will not be visible by any neighbors left-right center back or driving by on Cook Road because of mature trees along the street.

We are asking for permission and look forward to working to build a structure that will mirror the current house- garage appearance.

Thank you for your efforts and cooperation to achieve a structure that meets and exceeds the building requirements.

Regards,

Eileen Crotty-Sendor & Don Sendor

SUPERVISOR
Charles D. Snyder
(716) 652-7590
csnyder@townofaurora.com



TOWN CLERK
Martha L. Librock
(716) 652-3280
townclerk@townofaurora.com

TOWN OF AURORA

Aurora Municipal Center
575 Oakwood Avenue, East Aurora, NY 14052
www.townofaurora.com

TOWN COUNCIL MEMBERS

June 10, 2024

Luke Wochensky
lwochensky@townofaurora.com

James F. Granville
jgranville@townofaurora.com

Joseph M. McCann
jmccann@townofaurora.com

Raymond M. Wrazen
rwrazen@townofaurora.com

SUPT. OF HIGHWAYS
David M. Gunner
(716) 652-4050
highway@townofaurora.com

CODE ENFORCEMENT
OFFICER
Elizabeth Cassidy
(716) 652-7591
building@townofaurora.com

ASSESSOR
Stephen R. Pigeon
assessor@townofaurora.com
(716) 652-0011

DIR. OF RECREATION
Christopher Musshafen
(716) 652-8866
chris@townofaurora.com

TOWN ATTORNEY
Brigid M. Maloney

TOWN JUSTICE
Jeffrey P. Markello
Anthony DiFilippo IV

HISTORIAN
Robert L. Goller
(716) 652-7944
historian@townofaurora.com

FAX: (716) 652-3507

Donald Sendor
135 Cook Road
East Aurora, NY 14052

Donald:

The Building Department has reviewed your request to construct *an accessory structure (garage) in your front yard at 135 Cook Rd. (SBL 176.00-1-33.1)*. The request has been denied because it fails to meet the requirements for *no accessory buildings/structures in the front yard*.

Section 116-8.4(F)(4)
Required: No accessory buildings/structures shall be erected in the front yard.
Requested: Garage to be constructed in front yard located 100' from ROW.
Variance: Garage in front yard.

This letter serves as notice that we have received the application and fee for the Zoning Board of Appeals. You will receive notification from the Town Clerk with the date and time of the next available hearing. If you have any questions, please contact our office at 652-7591.

Sincerely,

Richard Miga
Assistant Code Enforcement Officer

**SITE PLAN OR ZONING REFERRAL TO COUNTY OF ERIE, N.Y.
AND REPLY TO MUNICIPALITY**

Submit this form with full statement of proposed action (as described in GML 239-m(c)) at www.Erie.gov/IRonline, OR mail a hard copy (retain a copy for your files) to: Erie County Division of Planning, 95 Franklin Street, Room 1053, Buffalo, N.Y., 14202

DO NOT WRITE IN THIS SPACE

Case No.: _____

Postmark/Delivery Date: _____

The proposed action described herein is referred in accordance with the provisions of NYS General Municipal Law §239 I - nn
A Municipal Referral Map is available to help determine whether an applicable action is subject to referral.

Description of Proposed Action

1. Name of Municipality: Town of Aurora

§239-m(4)(b) provides that the county shall have 30 days after receipt of a full statement of the proposed action to reply.

If the county fails to reply within such period, the referring body may take final action.

However, any county reply received after 30 days but 2 or more days prior to final action by the referring body shall be subject to §239-m(5)

The referring body shall file a report of its final action with the county within 30 days per §239-m(6).

2. Hearing Schedule: **Date** 7/18/2024 **Time** 7:00 p.m. **Location** 575 Oakwood Ave., E. Aurora

3. Action is before: Legislative Body Board of Appeals Planning Board

4. Action consists of: New Ordinance Rezone/Map Change Ordinance Amendment

Site Plan Variance Special Use Permit Other: _____

5. Location of Property: Entire Municipality Address: 135 Cook Road

5a. S.B.L. of Property: 176.00-1-33.1

6. Referral required as site is within 500' of: State or County Property/Institution Municipal Boundary Farm Operation located in an Agricultural District

Expressway County Road State Highway Proposed State or County Road, Property, Building/Institution, Drainageway

7. Proposed change or use: Proposed accessory building (garage) in the front yard of the residence is not allowed by Town Code.
(specify the action, such as the scope of variances or site plans)

8. Other remarks: _____

9. Submitted by: Martha Librock, Town Clerk Email: townclerk@townofaurora.com

10. Return Address: 575 Oakwood Ave., E. Aurora, NY 14052

Reply to Municipality by Erie County Division of Planning

Receipt of the above-described proposed action is acknowledged on _____. The Division herewith submits its review and reply under the provisions of applicable state and local law, based on the information submitted with this referral.

1. The proposed action is not subject to review under the law.
2. Comment on proposed action is attached hereto.
3. The proposed action is subject to review; Recommendation on Proposed Action is attached hereto.
4. No Recommendation; proposed action has been reviewed and determined to be of local concern.

By the Division of Planning: _____ **Date:** _____

Short Environmental Assessment Form

Part 1 - Project Information

Instructions for Completing

Part 1 – Project Information. The applicant or project sponsor is responsible for the completion of Part 1. Responses become part of the application for approval or funding, are subject to public review, and may be subject to further verification. Complete Part 1 based on information currently available. If additional research or investigation would be needed to fully respond to any item, please answer as thoroughly as possible based on current information.

Complete all items in Part 1. You may also provide any additional information which you believe will be needed by or useful to the lead agency; attach additional pages as necessary to supplement any item.

Part 1 – Project and Sponsor Information			
Name of Action or Project: Shed - Garage in front yard			
Project Location (describe, and attach a location map): 135 Cook Rd E.A. N.Y 14052			
Brief Description of Proposed Action: Shed - Garage placement on front yard on #2 gravel			
Name of Applicant or Sponsor: Eileen Crotty (Donald Sendor)		Telephone: 71	/
Address: 135 COOK RD		E-Mail: ds	@
City/PO: EAST AURORA		State: NY	Zip Code: 14052
1. Does the proposed action only involve the legislative adoption of a plan, local law, ordinance, administrative rule, or regulation? If Yes, attach a narrative description of the intent of the proposed action and the environmental resources that may be affected in the municipality and proceed to Part 2. If no, continue to question 2.		NO	YES
		<input checked="" type="checkbox"/>	<input type="checkbox"/>
2. Does the proposed action require a permit, approval or funding from any other government Agency? If Yes, list agency(s) name and permit or approval: TDA Building Permit		NO	YES
		<input type="checkbox"/>	<input checked="" type="checkbox"/>
3. a. Total acreage of the site of the proposed action?		7.8 acres	
b. Total acreage to be physically disturbed?		.013 acres	
c. Total acreage (project site and any contiguous properties) owned or controlled by the applicant or project sponsor?		7.8 acres	
4. Check all land uses that occur on, are adjoining or near the proposed action:			
<input type="checkbox"/> Urban <input type="checkbox"/> Rural (non-agriculture) <input type="checkbox"/> Industrial <input type="checkbox"/> Commercial <input checked="" type="checkbox"/> Residential (suburban)			
<input type="checkbox"/> Forest <input type="checkbox"/> Agriculture <input type="checkbox"/> Aquatic <input type="checkbox"/> Other(Specify):			
<input type="checkbox"/> Parkland			

5. Is the proposed action,	NO	YES	N/A
	<input type="checkbox"/>	<input checked="" type="checkbox"/>	<input type="checkbox"/>
a. A permitted use under the zoning regulations?	<input type="checkbox"/>	<input checked="" type="checkbox"/>	<input type="checkbox"/>
b. Consistent with the adopted comprehensive plan?	<input type="checkbox"/>	<input type="checkbox"/>	<input checked="" type="checkbox"/>
6. Is the proposed action consistent with the predominant character of the existing built or natural landscape?	NO	YES	
	<input type="checkbox"/>	<input checked="" type="checkbox"/>	
7. Is the site of the proposed action located in, or does it adjoin, a state listed Critical Environmental Area? If Yes, identify: _____	NO	YES	
	<input checked="" type="checkbox"/>	<input type="checkbox"/>	
8. a. Will the proposed action result in a substantial increase in traffic above present levels? b. Are public transportation services available at or near the site of the proposed action? c. Are any pedestrian accommodations or bicycle routes available on or near the site of the proposed action?	NO	YES	
	<input checked="" type="checkbox"/>	<input type="checkbox"/>	
	<input checked="" type="checkbox"/>	<input type="checkbox"/>	
	<input checked="" type="checkbox"/>	<input type="checkbox"/>	
9. Does the proposed action meet or exceed the state energy code requirements? If the proposed action will exceed requirements, describe design features and technologies: _____ <u>N/A</u> _____	NO	YES	
	<input checked="" type="checkbox"/>	<input type="checkbox"/>	
10. Will the proposed action connect to an existing public/private water supply? If No, describe method for providing potable water: _____ <u>N/A</u> _____	NO	YES	
	<input checked="" type="checkbox"/>	<input type="checkbox"/>	
11. Will the proposed action connect to existing wastewater utilities? If No, describe method for providing wastewater treatment: _____ <u>N/A</u> _____	NO	YES	
	<input checked="" type="checkbox"/>	<input type="checkbox"/>	
12. a. Does the project site contain, or is it substantially contiguous to, a building, archaeological site, or district which is listed on the National or State Register of Historic Places, or that has been determined by the Commissioner of the NYS Office of Parks, Recreation and Historic Preservation to be eligible for listing on the State Register of Historic Places? b. Is the project site, or any portion of it, located in or adjacent to an area designated as sensitive for archaeological sites on the NY State Historic Preservation Office (SHPO) archaeological site inventory?	NO	YES	
	<input checked="" type="checkbox"/>	<input type="checkbox"/>	
13. a. Does any portion of the site of the proposed action, or lands adjoining the proposed action, contain wetlands or other waterbodies regulated by a federal, state or local agency? b. Would the proposed action physically alter, or encroach into, any existing wetland or waterbody? If Yes, identify the wetland or waterbody and extent of alterations in square feet or acres: _____ <u>BEAR YARD</u> _____	NO	YES	
	<input type="checkbox"/>	<input checked="" type="checkbox"/>	
	<input checked="" type="checkbox"/>	<input type="checkbox"/>	

14: Identify the typical habitat types that occur on, or are likely to be found on the project site. Check all that apply:		
<input type="checkbox"/> Shoreline <input checked="" type="checkbox"/> Forest <input type="checkbox"/> Agricultural/grasslands <input type="checkbox"/> Early mid-successional <input type="checkbox"/> Wetland <input type="checkbox"/> Urban <input checked="" type="checkbox"/> Suburban		
15. Does the site of the proposed action contain any species of animal, or associated habitats, listed by the State or Federal government as threatened or endangered?	NO	YES
	<input checked="" type="checkbox"/>	<input type="checkbox"/>
16. Is the project site located in the 100-year flood plan?	NO	YES
	<input checked="" type="checkbox"/>	<input type="checkbox"/>
17. Will the proposed action create storm water discharge, either from point or non-point sources? If Yes,	NO	YES
	<input checked="" type="checkbox"/>	<input type="checkbox"/>
a. Will storm water discharges flow to adjacent properties?	<input checked="" type="checkbox"/>	<input type="checkbox"/>
b. Will storm water discharges be directed to established conveyance systems (runoff and storm drains)? If Yes, briefly describe:	<input checked="" type="checkbox"/>	<input type="checkbox"/>

18. Does the proposed action include construction or other activities that would result in the impoundment of water or other liquids (e.g., retention pond, waste lagoon, dam)? If Yes, explain the purpose and size of the impoundment:	NO	YES
	<input checked="" type="checkbox"/>	<input type="checkbox"/>

19. Has the site of the proposed action or an adjoining property been the location of an active or closed solid waste management facility? If Yes, describe:	NO	YES
	<input checked="" type="checkbox"/>	<input type="checkbox"/>

20. Has the site of the proposed action or an adjoining property been the subject of remediation (ongoing or completed) for hazardous waste? If Yes, describe:	NO	YES
	<input checked="" type="checkbox"/>	<input type="checkbox"/>

I CERTIFY THAT THE INFORMATION PROVIDED ABOVE IS TRUE AND ACCURATE TO THE BEST OF MY KNOWLEDGE Applicant/sponsor/name: <u>Eileen Crotty Donald R Saylor</u> Date: <u>6/6/24</u> Signature: <u>Eileen Crotty Donald R Saylor</u> Title: _____		

GAF
Timberline
HD
Shingles

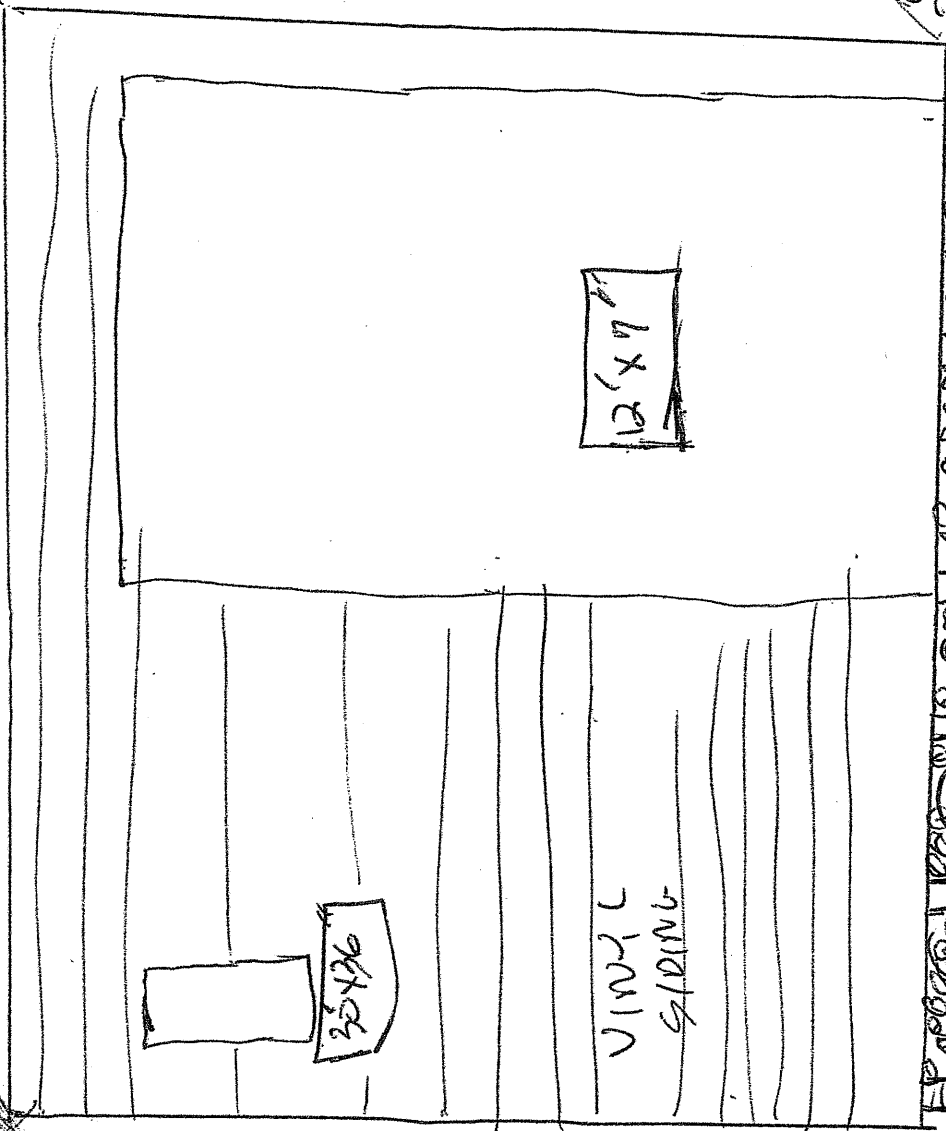
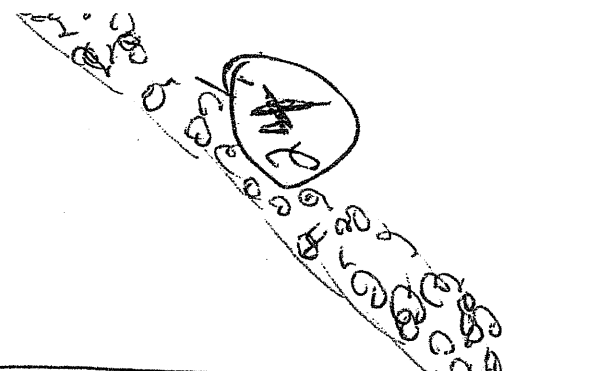

3 PANELS
2 # 2x4s & 2x6s

H
E

12' x 8'

30' x 36'

VINYL
SIDING

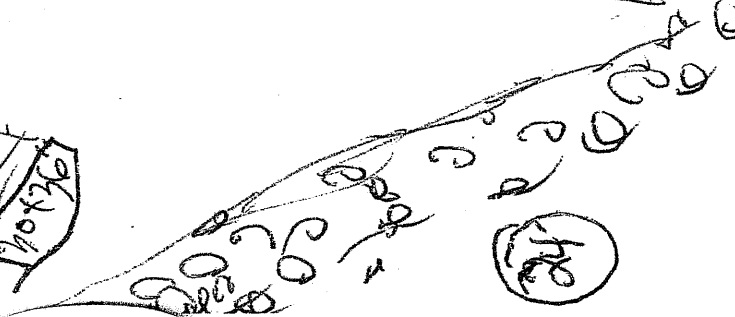
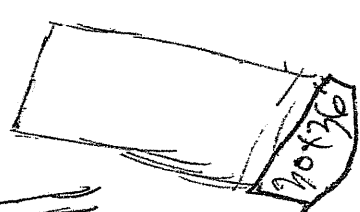
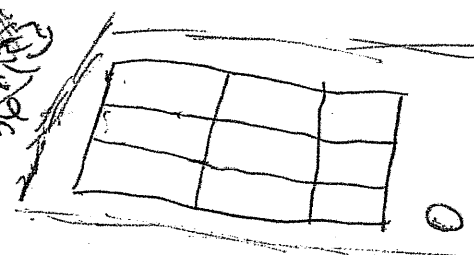

H
E

GARAGES



**24x28 Double Wide Garage
with 16'x7' Door**

*Garage sizes
and styles
are available
to fit every
lifestyle.*

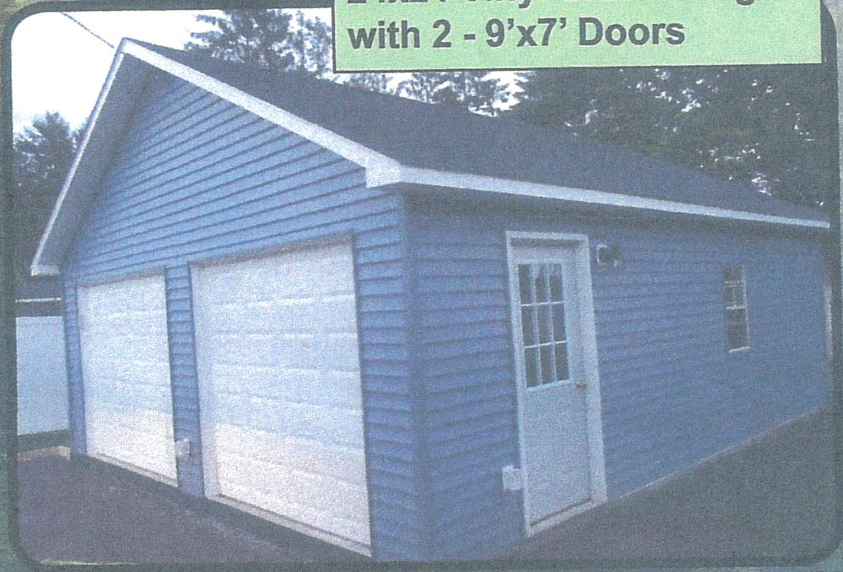

**24x24 Vinyl Side Garage
with 2 - 9'x7' Doors**

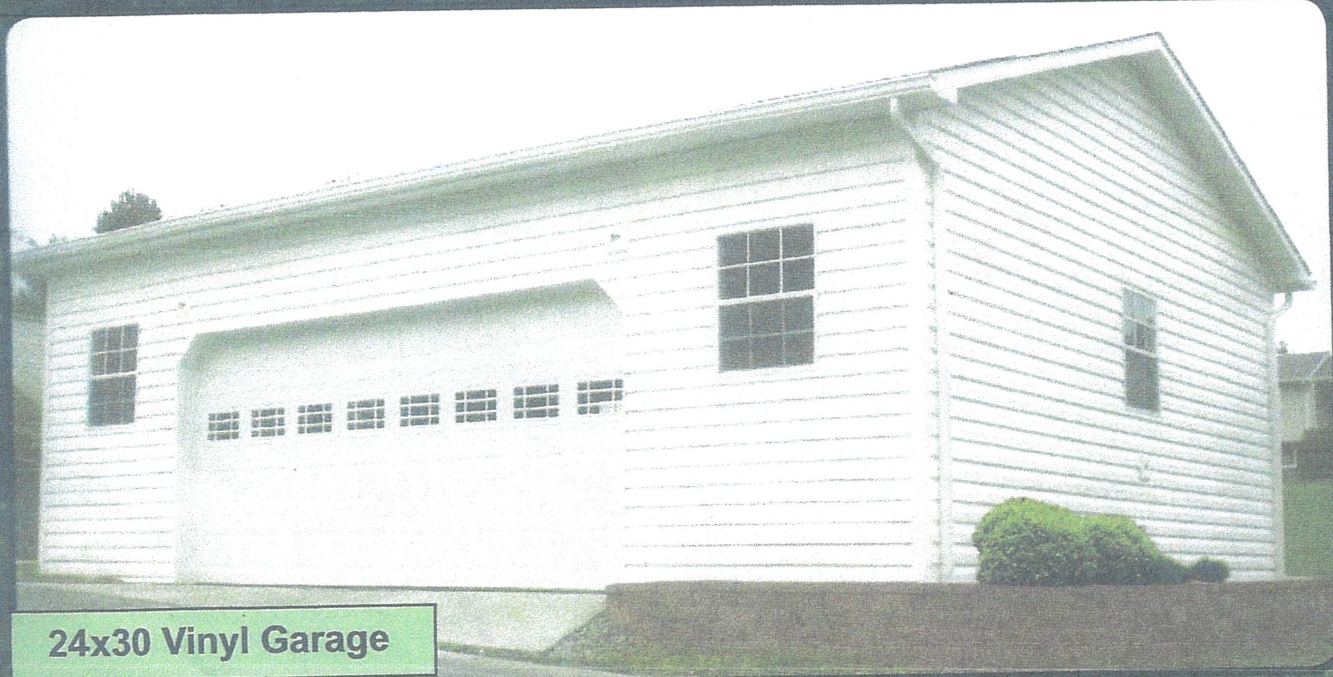

24x30 Vinyl Garage

AURORA

EXPRESSWAY

WEST LINE OF LOT 77

11.70 73.37 14.43

133.69 133.69

LANDS TAKEN BY N.Y.S. D.O.T
CONTRACT 5 - MAPS 857 & 872
PARC. 980 & 940

PARALLEL
3.75' P.C.

SOUTH LINE OF TOWN
L 8941 PG 554

1227.
1237.6

A PART OF LOT 77 TOWN
HOLLAND LAND CO.
TOWN OF PURDYS - N.Y.

SURVEY
SHIP 9. RANGE 6
BY SURVEY
E COUNTY - NEW YORK
DATE FEB 10. 1985

MEMS
RED
PARALLEL



20 RD A

133.25 1592.75 TO SOUTH LINE OF
BIG TREE ROAD

133.25 133.25
266.50

COOK ROAD
49.5' WIDE

Subplot 1





Erie County On-Line Mapping Application



Legend

- Parcels
- DEC Wetlands
- National Wetlands Inventory

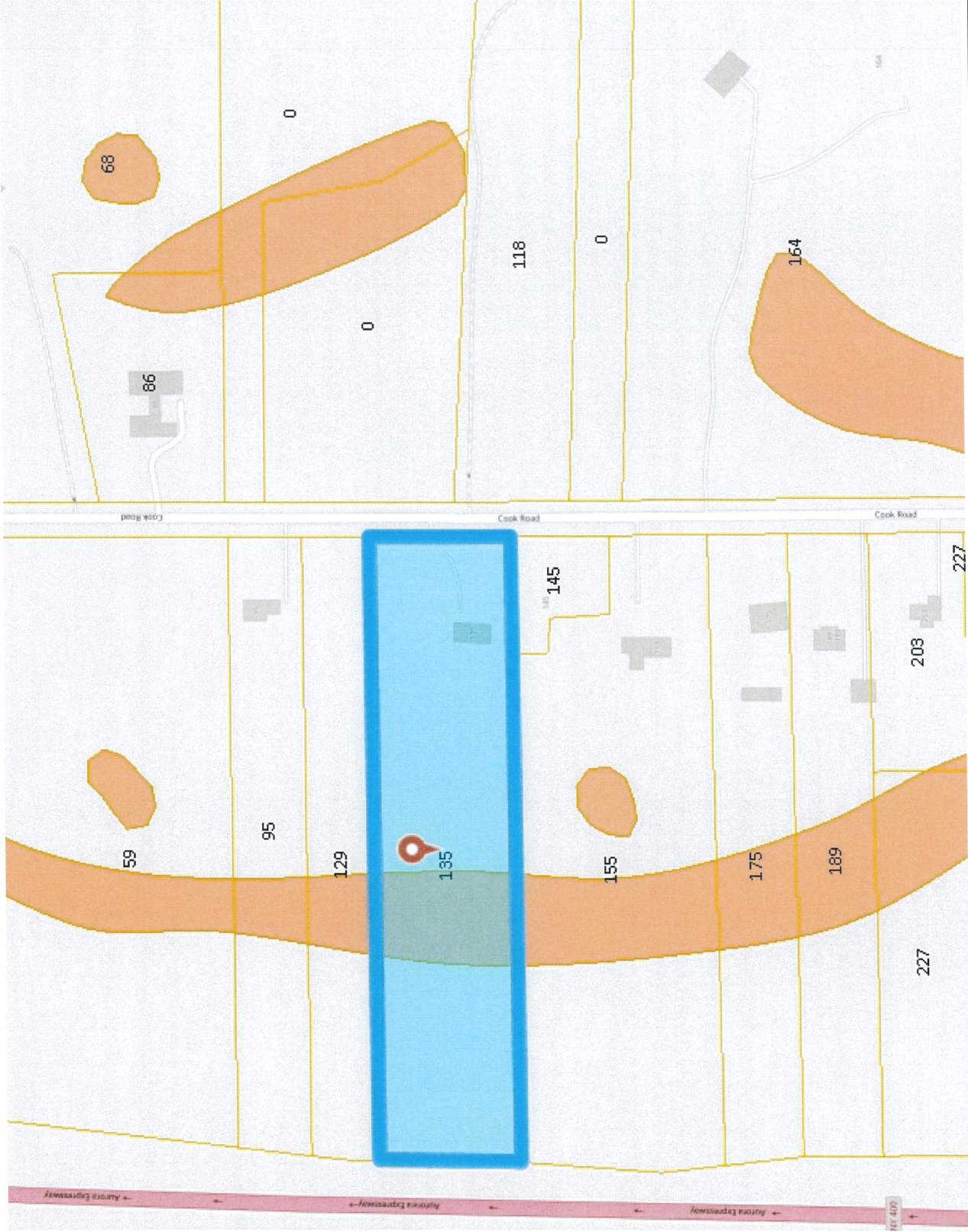

0 0.07 0.1 Miles

**ERIE COUNTY
DEPARTMENT OF ENVIRONMENT & PLANNING
OFFICE OF GIS**

This map is a user generated static output from an internet mapping site and is for reference only. Data layers that appear on this map may or may not be accurate, current, or otherwise reliable.



1: 4,514

WGS_1984_Web_Mercator_Auxiliary_Sphere
THIS MAP IS NOT TO BE USED FOR NAVIGATION



Erie County On-Line Mapping Application



Legend

□ Parcels



0 0.02 0.0Miles

WGS 1984 Web_Mercator_Auxiliary_Sphere
THIS MAP IS NOT TO BE USED FOR NAVIGATION

ERIE COUNTY
DEPARTMENT OF ENVIRONMENT & PLANNING
OFFICE OF GIS

This map is a user generated static output from an Internet mapping site and is for reference only. Data layers that appear on this map may or may not be accurate, current, or otherwise reliable.



1: 1,128









AURORA

EXPRESSWAY

WEST LINE OF LOT 77

11.70 73.37 14.43

133.69 133.69

LANDS TAKEN BY N.Y.S. D.O.T.
CONTRACT 5 - MAPS 857 & 872
PARC. 930 & 940

SOUTH LINE OF TOWN
L. 8941 PG 354

1227

1239.2

A PART OF LOT 7-70K
HOLLAND LAND CO.
TOWN OF BUZZSAW - 4

SUB

NEARS
ROAD
PUBLIC

DATE FEB 10 1985

SHIP 9-180N6 6
SUBVEY
COUNTY-NEW YORK

MEASURE

ROAD

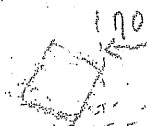

1102-0-16
91-0-0
89-52-36

133.25 1592.75 TO SOUTH LINE OF
816 TREE ROAD →

133.25 133.25
266.50

COOK

49.5 WIDE

ROAD

REIGHT





Erie County On-Line Mapping Application

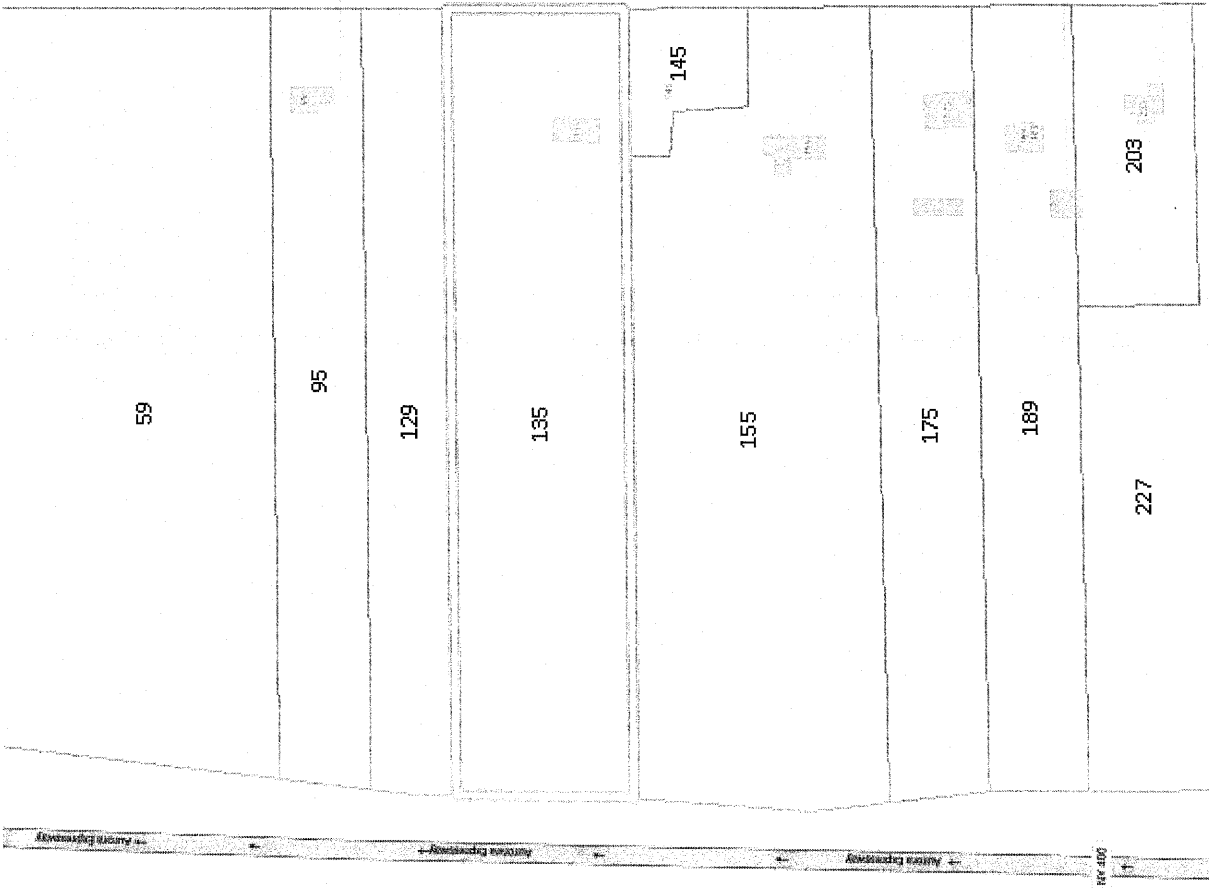

Legend

- Parcels

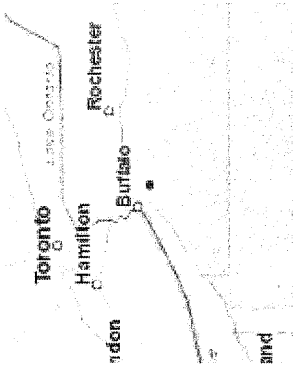

0 0,07 0,1 Miles

WGS_1984_Web_Mercator_Auxiliary_Sphere
THIS MAP IS NOT TO BE USED FOR NAVIGATION

ERIE COUNTY
DEPARTMENT OF ENVIRONMENT & PLANNING
OFFICE OF GIS

This map is a user generated static output from an Internet mapping site and is for reference only. Data layers that appear on this map may or may not be accurate, current, or otherwise reliable.



1: 4,514