

EXHIBIT L - 3

VISUAL RESOURCE EVALUATION



Looking northeast from intersection of Tanglewood Drive E and Edward Drive:
Proposed installation will not be visible from this location.

Distance from the photographic location to the proposed installation is \pm 1.36 miles.

Tectonic

MARKET RESEARCH & ANALYTICAL SERVICES

P-18

11947.004



Looking northeast from Birdsong Park Nature Trail parking area.
Proposed installation will not be visible from this location.

Distance from the photographic location to the proposed installation is ± 1.69 miles.

Tectonic

PAUL D. ORLANDI, INC. • RESIDENTIAL SERVICES

P-19

11947.004



Tectonic

PAK II | 50' x 100' | 100' x 100' | 100' x 100' | 100' x 100'

Looking north-northeast from 4565 Transit Road.
Proposed installation will be partially visible from this location.

Distance from the photographic location to the proposed installation is ± 0.44 miles.

P-20

11947.004



Tectonic

PAUL D. GALT CONSULTING, INC. • 3650 WILSON AVENUE, SUITE 100 • WASHINGTON, DC 20007

Looking north-northeast from 4565 Transit Road.
Proposed installation will be partially visible from this location.

Distance from the photographic location to the proposed installation is ± 0.44 miles.

S-20

11947.004



Tectonic

PAULI COLLEGE LIBRARY RESEARCH CENTER

Looking east from 66 Coventry Lane.
Proposed installation will be partially visible from this location.
Distance from the photographic location to the proposed installation is ± 1.41 miles.

P-21

11947.004

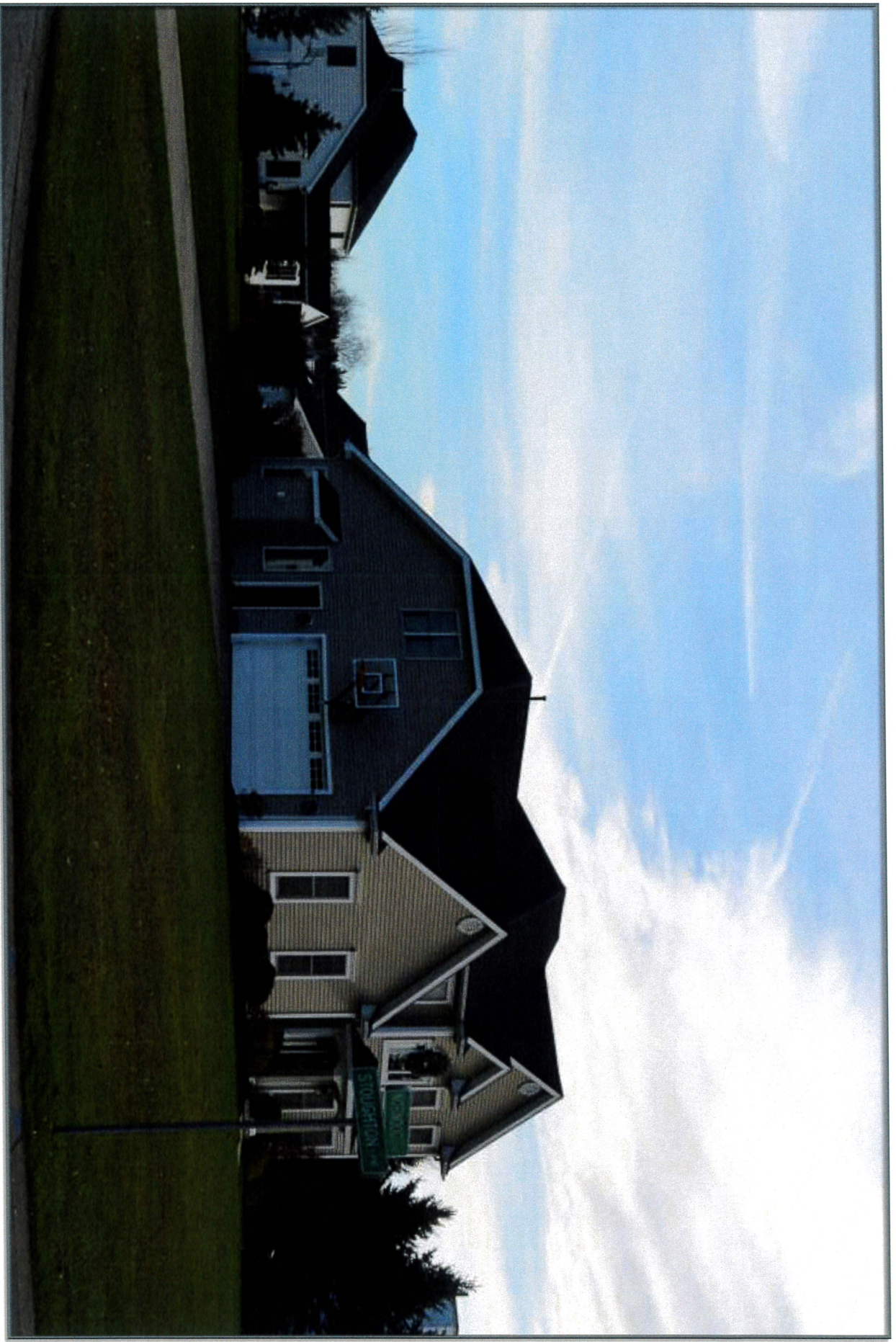

Looking southeast from intersection of Norwood Lane and Stoughton Lane.
Proposed installation will not be visible from this location.

Distance from the photographic location to the proposed installation is ± 1.42 miles.

Tectonic

PLANNING AND CONSULTING SERVICES

P-22

11947.004



Looking southeast from intersection of Graystone Lane and Montclair Lane.
Proposed installation will not be visible from this location.

Distance from the photographic location to the proposed installation is ± 1.60 miles.

Tectonic

PLANNING CONSULTING & DESIGN SERVICES, INC.

P-23

11947.004

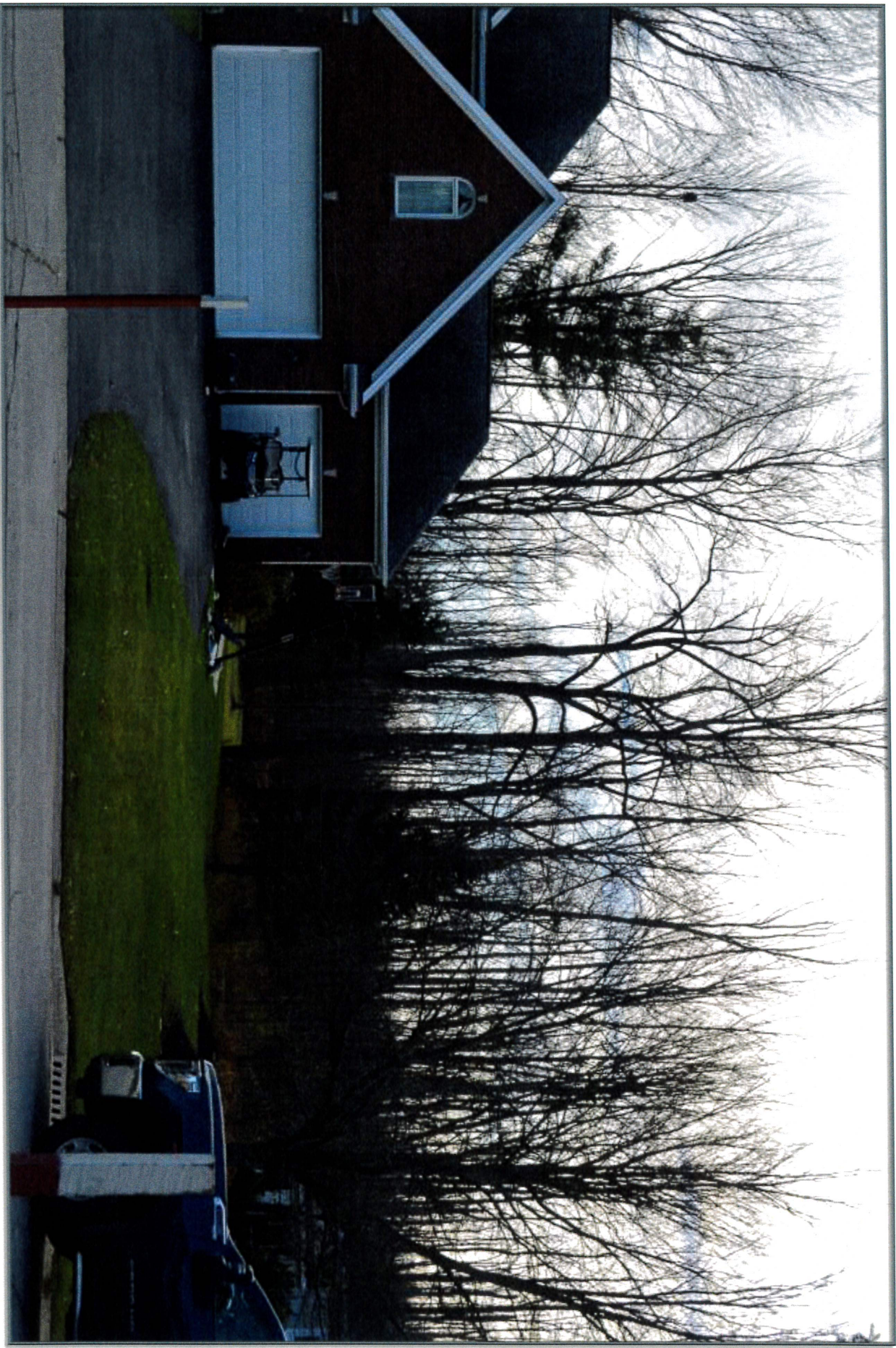

Tectonic

PHOTO: MATT HILLYER - SKENETECH/SHUTTERSTOCK

Looking south-southeast from Ponderosa Ct (loop).
Proposed installation will not be visible from this location.

Distance from the photographic location to the proposed installation is ± 1.31 miles.

P-24

11947.004



Tectonic

PHOTO COURTESY OF TECTONIC AVIATION

Looking south from 741 Transit Road.
Proposed installation will not be visible from this location.

Distance from the photographic location to the proposed installation is \pm 1.42 miles.

P-25

11947.004



Looking south from 3444 Transit Road.
Proposed installation will not be visible from this location.

Distance from the photographic location to the proposed installation is \pm 1.79 miles.

Tectonic

PLANNING • DESIGN • CONSTRUCTION SERVICES

P-26

11947.004



Tectonic

PHOTOGRAPHY BY SPENCER BROWN

Looking south-southwest from 250 Stonybrook Road.
Proposed installation will be partially visible from this location.

Distance from the photographic location to the proposed installation is ± 0.86 miles.

P-27

11947.004



Tectonic

MAKING THE WORLD BETTER, ONE PROJECT AT A TIME

Looking south-southwest from 100 Stonybrook Road.
Proposed installation will be visible from this location.

Distance from the photographic location to the proposed installation is \pm 0.52 miles.

P-28

11947.004

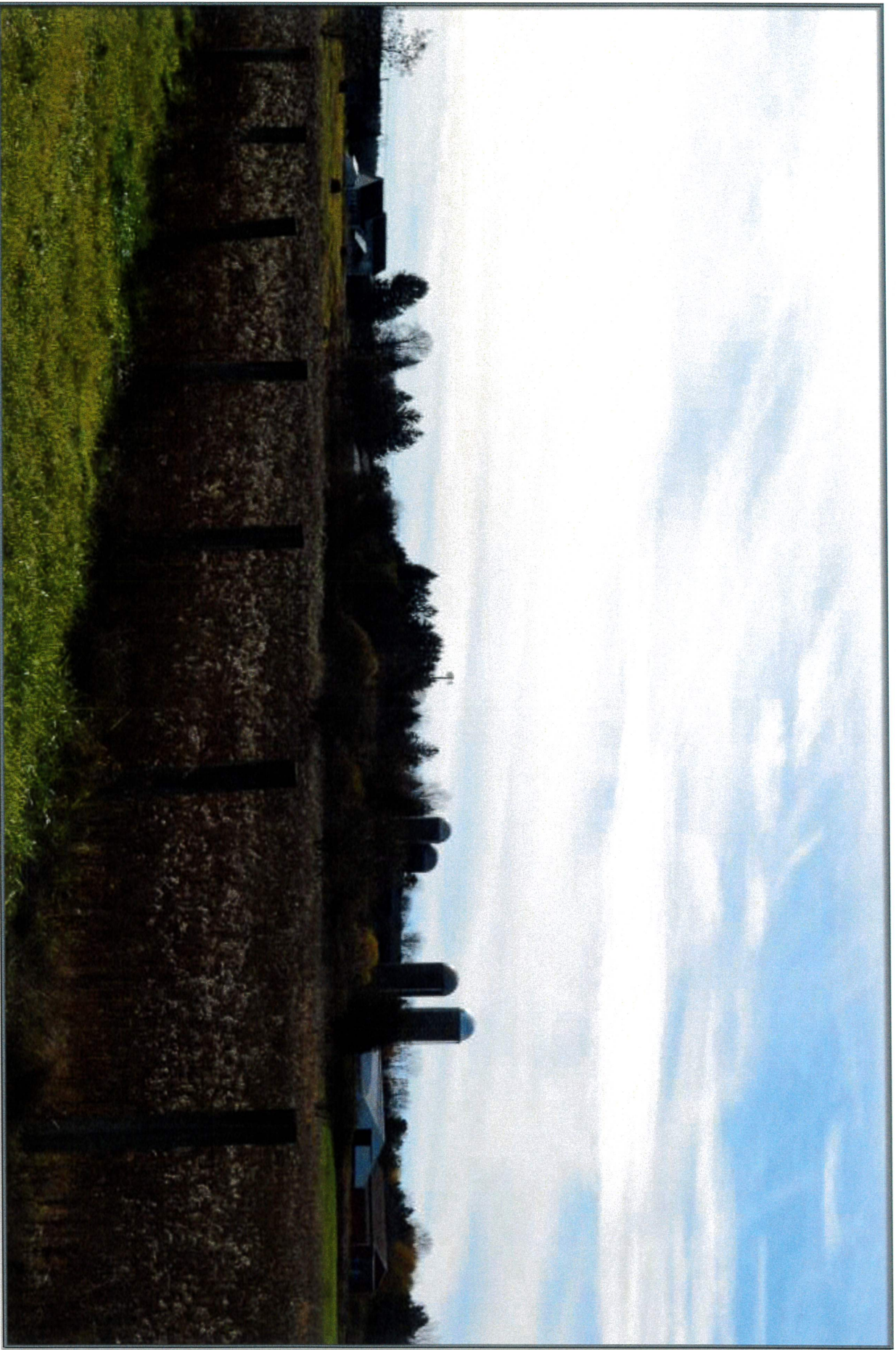

Looking south-southwest from 100 Stonybrook Road.
Proposed installation will be visible from this location.

Distance from the photographic location to the proposed installation is \pm 0.52 miles.

Tectonic

PHOTO: T. S. MOULTON/USDA/NATIONAL ARCHAEOLOGICAL SERVICE

S-28

11947.004



Looking southwest from 744 Willardshire Road.
Proposed installation will not be visible from this location.

Distance from the photographic location to the proposed installation is \pm 1.28 miles.

Tectonic

PROFESSIONAL ENGINEERING & ARCHITECTURAL SERVICES

P-29

11947.004