

**NY AURORA I, LLC &
NY AURORA II, LLC.**

Community Solar
Farm Project

637 Davis Road
Aurora, NY 14052

**DELAWARE RIVER
SOLAR**

140 EAST 45TH STREET
SUITE 32B-1
NEW YORK NY, 10017



Bergmann Associates, Architects, Engineers,
Landscape Architects & Surveyors, D.P.C.
280 East Broad Street
Suite 200
Rochester, NY 14604
office: 585.232.5135
fax: 585.232.4652
www.bergmannpc.com

NO.	DATE	REVISIONS	CK'D
		DESCRIPTION	REV.

LEGEND

- PIN OR REBAR FOUND
- PIPE FOUND
- UTILITY POLE
- GAS VALVE
- CHAIN LINK FENCE
- OVERHEAD UTILITY WIRE
- PROPERTY LINE
- ADJOINING PROPERTY LINE
- RIGHT OF WAY LINE

**PROPERTY SITUATE IN THE
TOWN OF AURORA,
COUNTY OF ERIE,
STATE OF NEW YORK**

LOT 61, TOWNSHIP 9, RANGE 6

Copyright © Bergmann Associates, Architects, Engineers,
Landscape Architects & Surveyors, D.P.C.

Note:
Unauthorized alteration or addition to this drawing is a violation of
the New York State Education Law Article 145, Section 7209.

Project Manager:	Drawn By:
Designed By:	Scale:
Date Issued:	1" = 100'
Project Number:	
12773.59	

WE, BERGMANN ASSOCIATES, DO HEREBY CERTIFY THAT THIS MAP WAS MADE FROM THE NOTES OF
AN INSTRUMENT SURVEY MADE AND FROM THE LIBER 11066, PAGE 1853

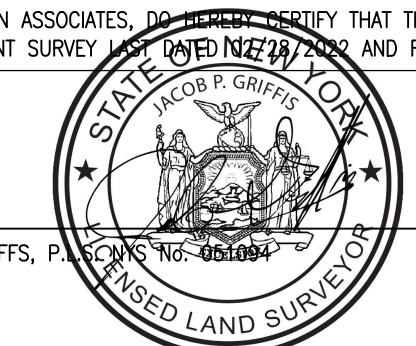

JACOB P. GRIFFS, P.E.
DATE 3/11/2022

BOUNDARY SURVEY

Drawing Number: