

DAVIS (66' WIDE) ROAD
(ALSO KNOWN AS ROUTE 240)

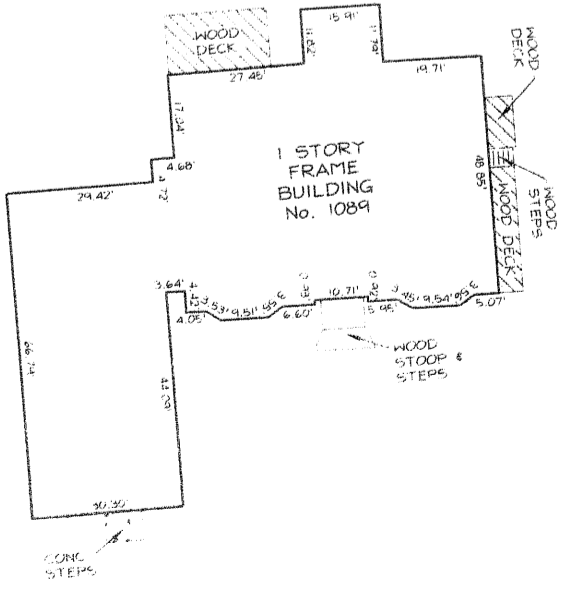

NOTE: PHYSICAL FEATURES AT GROUND LEVEL, NOT CHECKED AND/OR LOCATED DUE TO THE PRESENCE OF EXCESSIVE SNOW AND/OR ICE

NUSSBAUMER & CLARKE, INC.
ENGINEERS AND SURVEYORS
EST. 1937

509 Main Street P.O. Box 516 East Aurora NY 14052
P (716) 655-1058 F (716) 655-1964 www.nussclark.com

This survey was prepared with reference to
Seward Title Insurance Company Abstract
No. 314250 dated February 27, 2019

Unauthorized alterations or additions to any survey drawing
constitute a violation of Section
7209, Article 81 of the New York State Education Law

BOUNDARY SURVEY
1089 DAVIS ROAD
Part of Lot 60, Township 9, Range 6
Holland Land Company's Survey
Town of Aurora
County of Erie State of New York

Date of Survey 2/28/19

Scale 1" = 50' Project No. 1913-0069

Thornton R. Kopyov

NO IRONS SET OR FOUND AT PROPERTY CORNERS UNLESS NOTED HEREON

NO IRONS SET OR FOUND AT PROPERTY CORNERS UNLESS NOTED HEREON

Subordinate to the orders of the State Surveyors